



Installation Procedure

Watson Bowman Acme Corp. 95 Pineview Drive Amherst, NY 14228

phone: (716) 691-7566 fax: (716) 691-9239

website: www.wbcorp.com

Information provided herein, including but not limited to, any drawing, design, photograph, graphic, or statement(s) ("Materials") are proprietary and the property of Watson Bowman Acme Corporation ("Company"). Reproduction, translation, or reduction to any electronic medium or machine readable form, in whole or part, is strictly prohibited, except for the express purpose for which it has been furnished, without prior written consent of Company. All Materials contained herein are provided by Company for information purposes only. Company reserves the right to amend or withdraw any information contained in the Materials without notice. All technical or other advice by Company, whether verbal or written, concerning products, or the use of products in specific situations ("Advice") is given by Company and is used at the Users own risk.



Wabo® SeismaxPlus - Professional Series Model(s) "NBW-400 thru 2400" Vertical Expansion Control Systems

The following installation procedure is very important and must be fully understood prior to beginning any work. To ensure proper installation and performance of expansion joint system the following actions must be completed by the installing contractor. Failure to do so will affect product warranty.

- 1) Carefully read and understand installation procedure. Contact WBA's Technical Service Department at (800) 677-4922 for product assistance.
- 2) Inspect all shipments and materials for missing or damaged components and hardware. Contact Customer Service at (800) 677-4922 with WBA's order number and invoice for prompt assistance.
- 3) Inspect substrate or adjacent construction for acceptance before beginning work. Report unacceptable construction to the project manager for scheduled repair work.
- 4) Review WBA shop drawings for project specific detailed information if Engineering services were purchased at time of order.

Standard Components For Wall Condition



1/4" X 1 1/4" Lg Screw
P/n: 5621



Aluminum Base Extrusion
P/n: 15244



Elastomeric Seal
P/n: 15340 (Black)
P/n: 15341 (Beige)
P/n: 15342 (Grey)
P/n: 15343 (White)

Components shown below vary in size depending on model of system

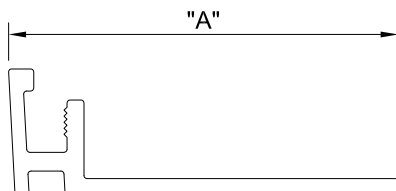

Aluminum Edge Extension
(Refer to Chart Below for sizes and P/n)

Model	P/N	"A"
NBW-400	15800	1 15/16"
NBW-600/800	15801	2 15/16"
NBW-1000/1200/1800/2400	15802	3 15/16"

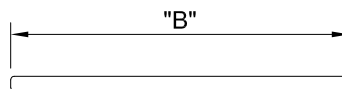

Filler Panel
(Refer to Chart Below for sizes and P/n)

Model	P/N	"B"
NBW-1800	15781	2 3/4"
NBW-2400	15782	4 1/4"

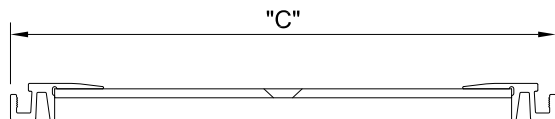

Aluminum Center Slide Plate
(Refer to Chart Below for sizes and P/n)

Model	P/N	"C"
NBW-400	15784	7 5/8"
NBW-600	15785	11 5/8"
NBW-800	15786	13 5/8"
NBW-1000	15787	17 5/8"
NBW-1200	15788	19 5/8"
NBW-1800	15789	29 1/8"
NBW-2400	15790	38 1/8"

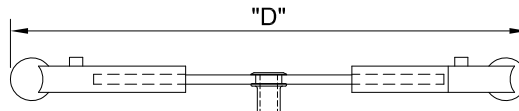

Seismic Centering Bar
(Refer to Chart Below for sizes and P/n)

Model	P/N	"D"
NBW-400	15630	18 3/8"
NBW-600	15630	18 3/8"
NBW-800	15630	18 3/8"
NBW-1000	15631	22 3/8"
NBW-1200	15631	22 3/8"
NBW-1800	15603	26 3/8"
NBW-2400	15641	50 3/8"

Sheet
1
of 5

Watson Bowman Acme Corp.
95 Pineview Drive Amherst, NY 14228
phone: (716) 691-7566 fax: (716) 691-9239
website: www.wbacorp.com

Installation procedure: SeismaxPlus NBW system

Information provided herein, including but not limited to, any drawing, design, photograph, graphic, or statement(s) ("Materials") are proprietary and the property of Watson Bowman Acme Corporation ("Company"). Reproduction, translation, or reduction to any electronic medium or machine readable form, in whole or part, is strictly prohibited, except for the express purpose for which it has been furnished, without prior written consent of Company. All Materials contained herein are provided by Company for information purposes only. Company reserves the right to amend or withdraw any information contained in the Materials without notice. All technical or other advice by Company, whether verbal or written, concerning products, or the use of products in specific situations ("Advice") is given by Company and is used at the Users own risk.



Installation Procedure

Sheet
2
of 5

Watson Bowman Acme Corp.
95 Pineview Drive Amherst, NY 14228
phone: (716) 691-7566 fax: (716) 691-9239
website: www.wbacorp.com

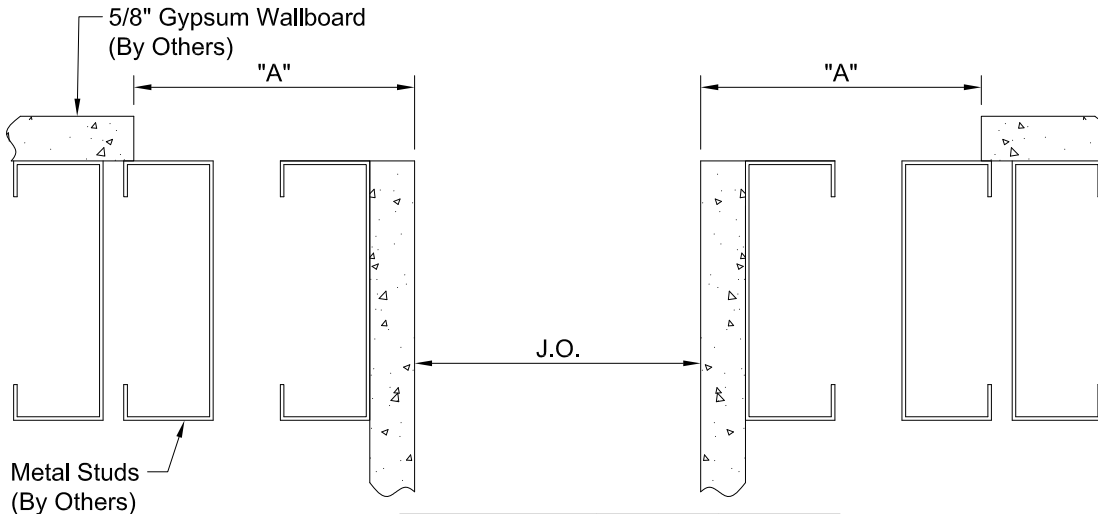

Model	"A"	J.O.
NBW-400	3 15/16"	4"
NBW-600	4 15/16"	6"
NBW-800	4 15/16"	8"
NBW-1000	5 15/16"	10"
NBW-1200	5 15/16"	12"
NBW-1800	7 11/16"	18"
NBW-2400	9 3/16"	24"

1

Prior to beginning work, installer shall inspect for proper wall construction. Verify joint opening as called for on chart.

Note: Non-Rated wall detail shown above. For rated wall installations, contact project architect to ensure that wall has been properly designed to maintain rating to accept Expansion Joint and Fire Barrier Systems.

Installation procedure: SeismaxPlus NBW system

Information provided herein, including but not limited to, any drawing, design, graphic, or statement(s) ("Materials") are proprietary and the property of Watson Bowman Acme Corporation ("Company"). Reproduction, translation, or reduction to any electronic medium or machine readable form, in whole or part, is strictly prohibited, except for the express purpose for which it has been furnished, without prior written consent of Company. All Materials contained herein are provided by Company for information purposes only. Company reserves the right to amend or withdraw any information contained in the Materials without notice. All technical or other advice by Company, whether verbal or written, concerning products, or the use of products in specific situations ("Advice") is given by Company and is used at the Users own risk.

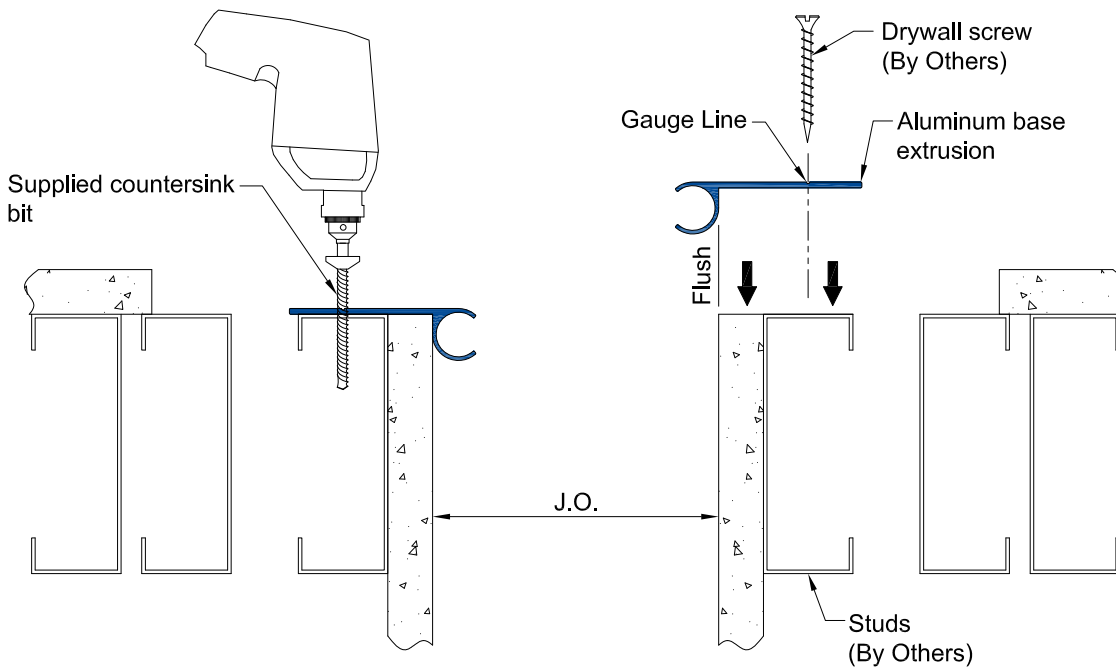

2

Place aluminum base extrusion on edge of opening as shown. Utilizing supplied countersink bit, drill through base extrusion at the gauge line and into stud. Fasten with drywall screws (By Others) spaced at 24" O.C. maximum, start 12" from ends.

Note: See step 3 next page before installing all base members.



Installation procedure: SeismaxPlus NBW system

Information provided herein, including but not limited to, any drawing, design, photograph, graphic, or statement(s) ("Materials") are proprietary and the property of Watson Bowman Acme Corporation ("Company"). Reproduction, translation, or reduction to any electronic medium or machine readable form, in whole or part, is strictly prohibited, except for the express purpose for which it has been furnished, without prior written consent of Company. All Materials contained herein are provided by Company for information purposes only. Company reserves the right to amend or withdraw any information contained in the Materials without notice. All technical or other advice by Company, whether verbal or written, concerning products, or the use of products in specific situations ("Advice") is given by Company and is used at the Users own risk.

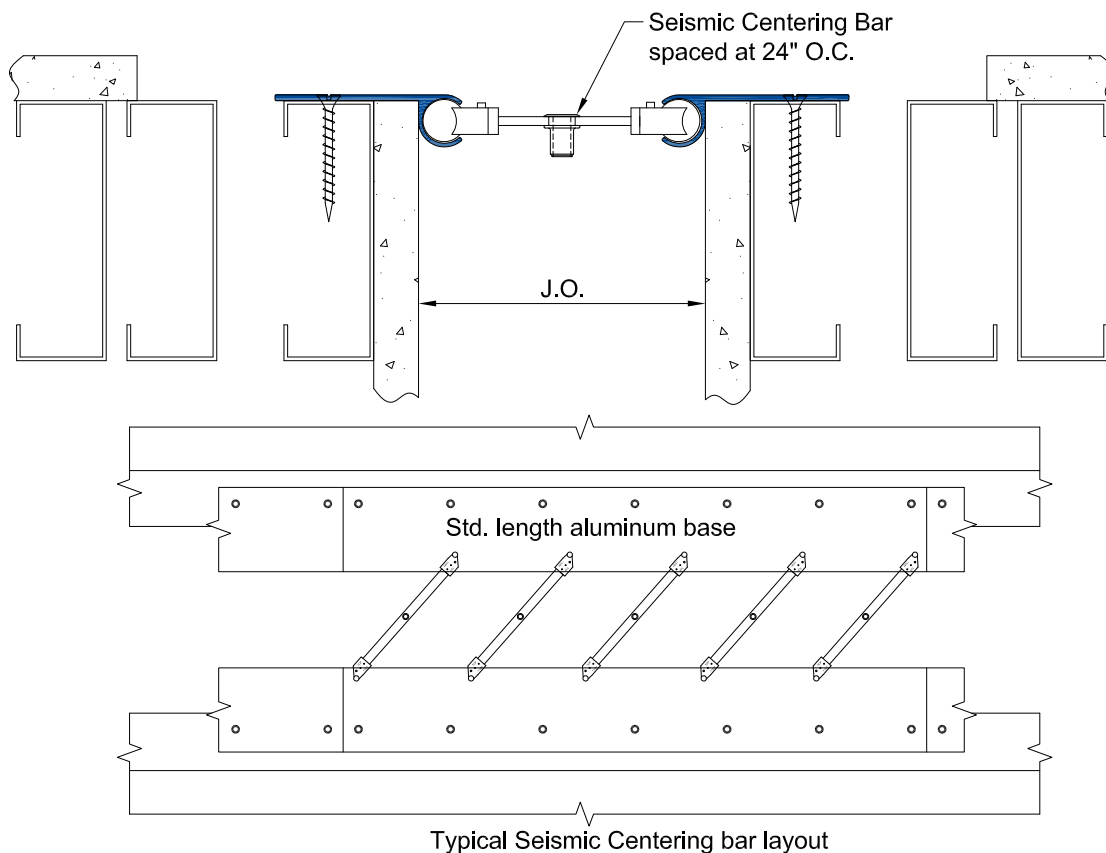

3

As you install aluminum base member sections, slide Seismic Centering bars into circular cavities. Make sure that "TOP" indicator is facing out and that all bars are in same orientation. Utilize duct tape or something similar to hold bars in position and vertical spacing @ 24" O.C. until slide plate is installed.

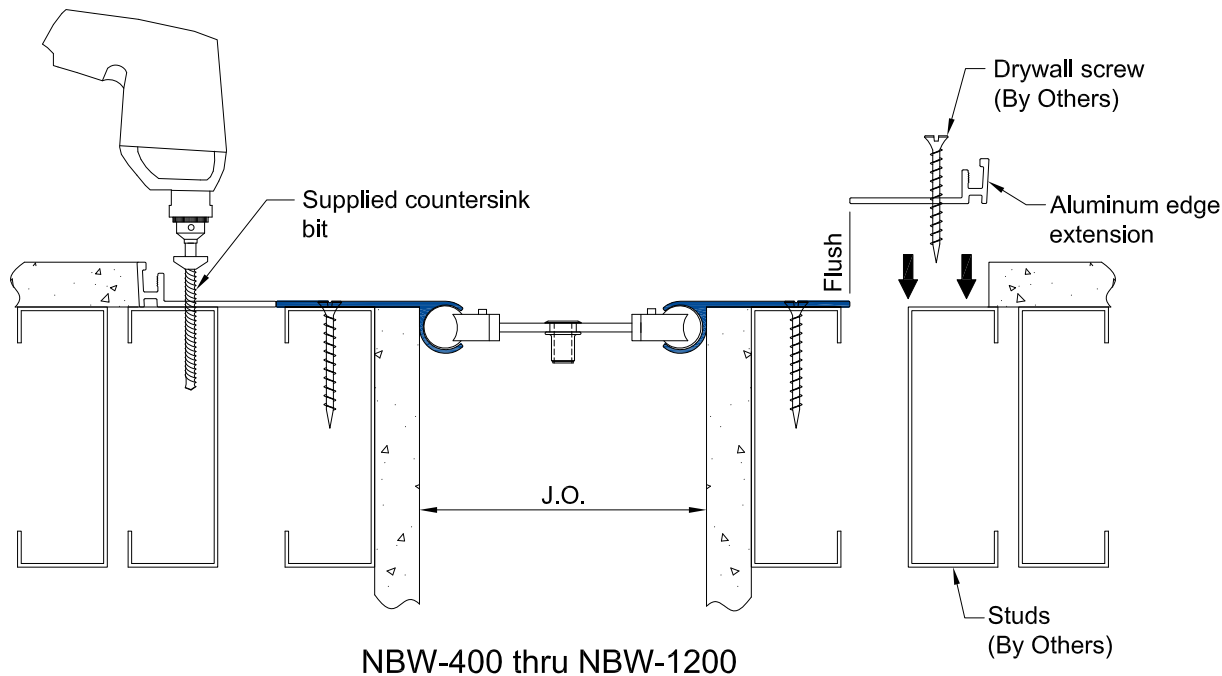

4

Place aluminum edge extension flush with the edge of aluminum base extrusion as shown. Utilizing supplied countersink bit, drill through extrusion and into stud. Fasten with drywall screws (By Others) spaced at 24" O.C. maximum, start 12" from ends.

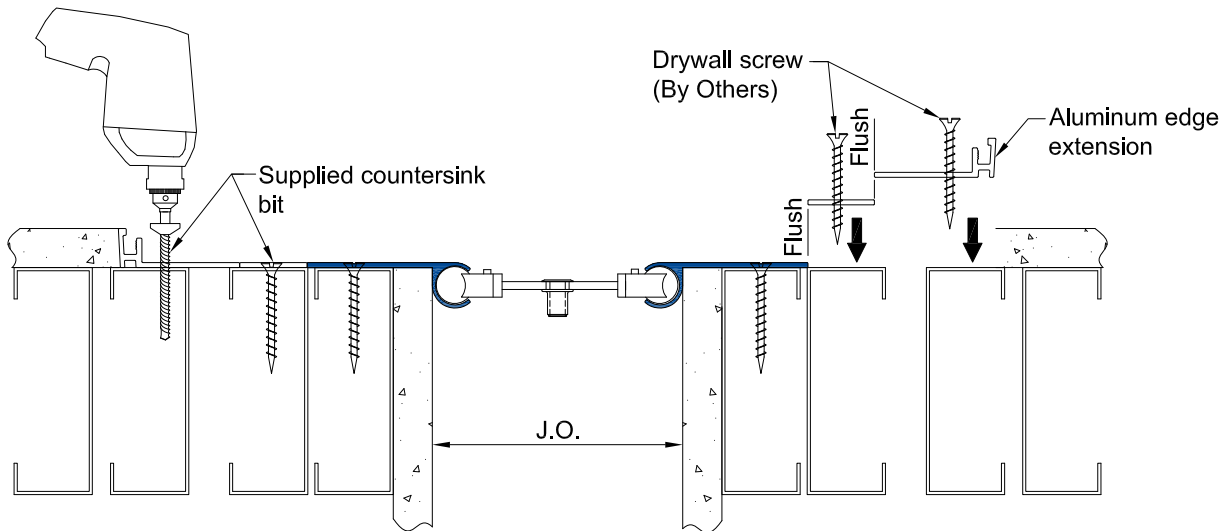

NBW-1800 thru NBW-2400

Filler Plate:

On NBW-1800 thru NBW-2400 systems, before aluminum edge extension can be installed, filler plates must be inserted flush with the edge of aluminum base extrusion as shown above. Utilizing supplied countersink bit, drill through extrusion and into stud. Fasten with drywall screws (By Others) spaced at 24" O.C. maximum, start 12" from ends.

Aluminum Edge Extension:

After filler plate has been installed, place aluminum edge extension flush with the edge of filler plate as shown above. Utilizing supplied countersink bit, drill through extrusion and into stud. Fasten with drywall screws (By Others) spaced at 24" O.C. maximum, start 12" from ends.

4A

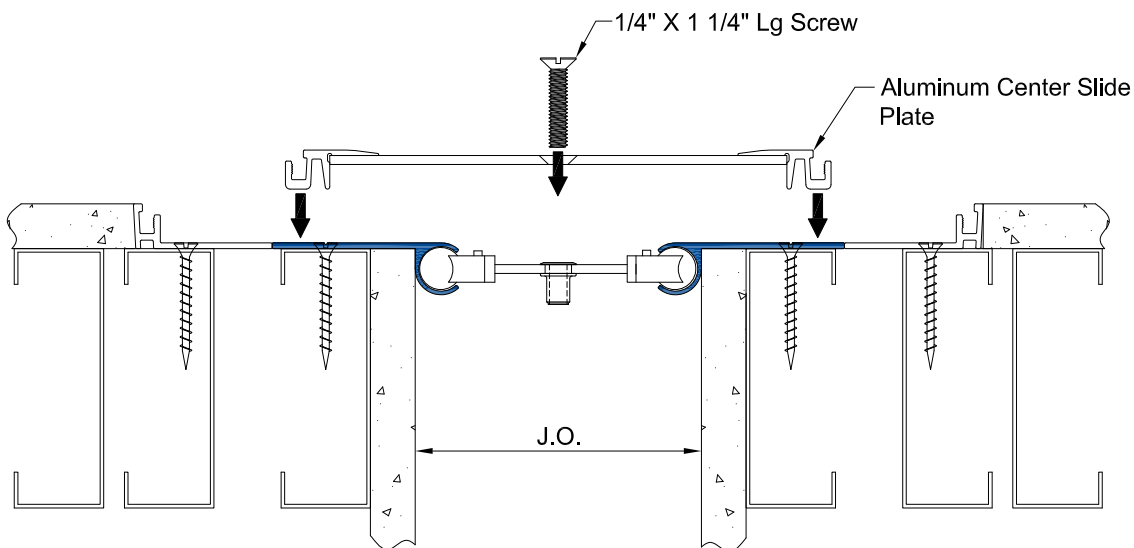

5

Position the Center Slide Plate over expansion opening, Align pre-drilled holes in slide plate with threaded insert in Seismic Centering bars. Fasten with 1/4" X 1-1/4" Csk Flat Screw. Tighten to create measurable tension in the bar. Do Not Overtighten.

Installation procedure: SeismaxPlus NBW system

Information provided herein, including but not limited to, any drawing, design, photograph, graphic, or statement(s) ("Materials") are proprietary and the property of Watson Bowman Acme Corporation ("Company"). Reproduction, translation, or reduction to any electronic medium or machine readable form, in whole or part, is strictly prohibited, except for the express purpose for which it has been furnished, without prior written consent of Company. All Materials contained herein are provided by Company for informational purposes only. Company reserves the right to amend or withdraw any information contained in the Materials without notice. All technical or other advice by Company, whether verbal or written, concerning products, or the use of products in specific situations ("Advice") is given by Company and is used at the Users own risk.

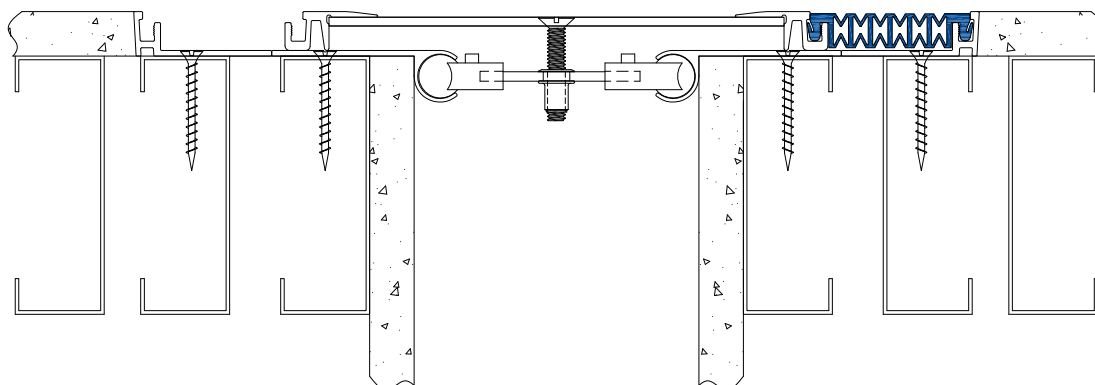
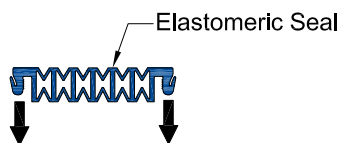

6

Position Seal lug over Extrusion cavity and insert lug into cavity using thumb pressure for initial insertion. Once Elastomeric Seal is inserted, run thumb along top of lug to ensure complete lug insertion.

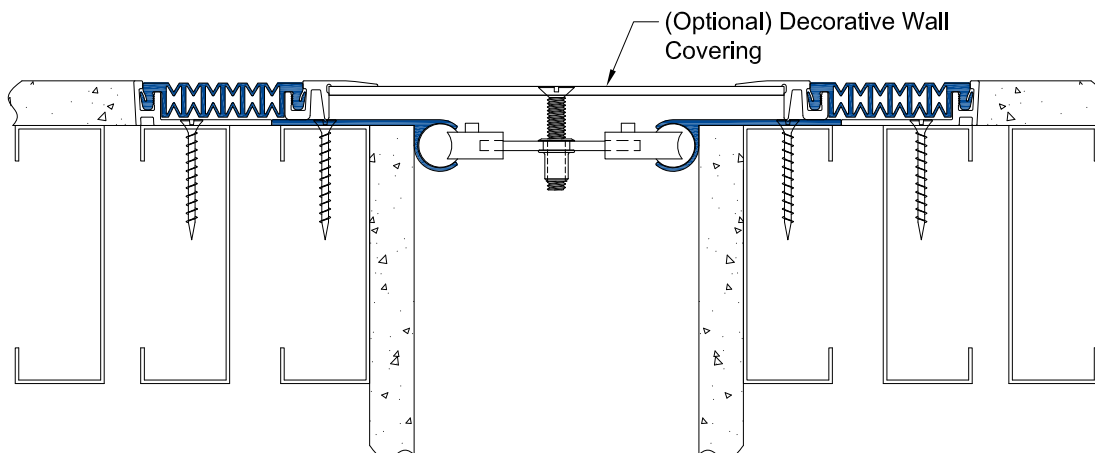

7

Optional:

Wipe down aluminum slide plate to remove dust particles prior to applying decorative wall covering materials.

Caution: Contact Wall Covering Materials Manufacturer to discuss product application and procedure for proper installation. Screw heads should be covered with tape to avoid slot in screw head from telegraphing through wall covering.