



Installation Procedure

Watson Bowman Acme Corp. 95 Pineview Drive Amherst, NY 14228

phone: (716) 691-7566 fax: (716) 691-9239

website: www.wbacorp.com

Information provided herein, including but not limited to, any drawing, design, photograph, graphic, or statement(s) ("Materials") are proprietary and the property of Watson Bowman Acme Corporation ("Company"). Reproduction, translation, or reduction to any electronic medium or machine readable form, in whole or part, is strictly prohibited, except for the express purpose for which it has been furnished, without prior written consent of Company. All Materials contained herein are provided by Company for information purposes only. Company reserves the right to amend or withdraw any information contained in the Materials without notice. All technical or other advice by Company, whether verbal or written, concerning products, or the use of products in specific situations ("Advice") is given by Company and is used at the Users own risk.

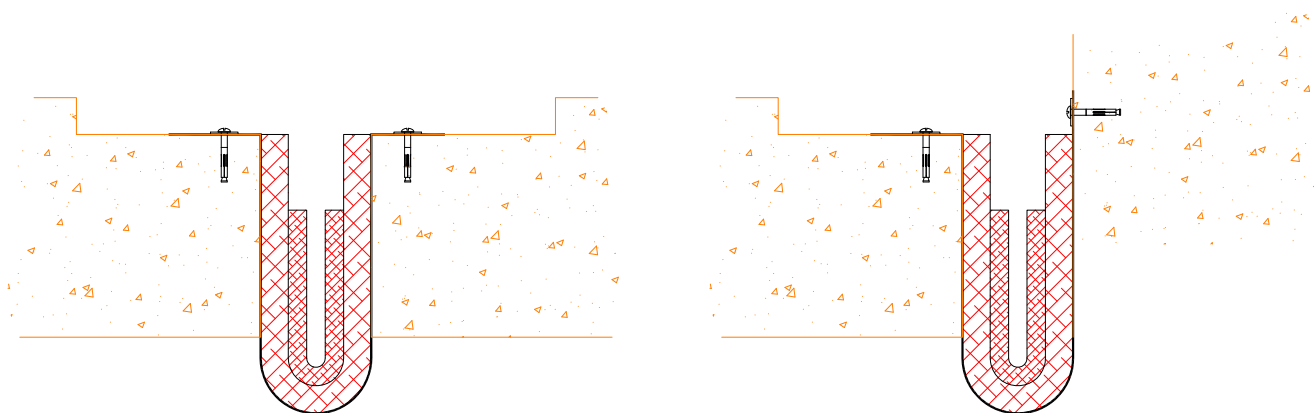

Wabo® FlameGuard II - Life Safety Series Model(s) "HFG" & "HFG Corner" 2" Horizontal Fire Barrier Systems

The following installation procedure is very important and must be fully understood prior to beginning any work. To ensure proper installation and performance of expansion joint system the following actions must be completed by the installing contractor. Failure to do so will affect product warranty and fire barrier performance.

- 1) Carefully read and understand installation procedure. Contact WBA's Technical Service Department at (800) 677-4922 for product assistance.
- 2) Inspect all shipments and materials for missing or damaged components and hardware. Contact Customer Service at (800) 677-4922 with WBA's order number and invoice for prompt assistance.
- 3) Inspect substrate or adjacent construction for acceptance before beginning work. Report unacceptable construction to the project manager for scheduled repair work.
- 4) Review WBA shop drawings for project specific detailed information if Engineering services were purchased at time of order.

Standard Components For Floor Condition

Sheet
1
of 4

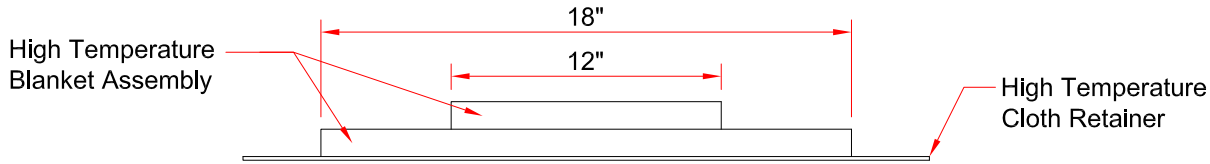

Flameguard II 2" Floor Assembly
(For size and p/n refer to chart)

Model #	Part # 4 hr
HFG-204	HFG204

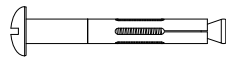

1/4" X 1 1/2" Concrete
Sleeve Anchor
Part Number - xxxx



1/4" Flat Washer
Part Number - #7473



Hilti CFS-S SIL GG Sealant
Part Number - #2861

Components shown below vary in size depending
on model of system

Watson Bowman Acme Corp.
95 Pineview Drive Amherst, NY 14228
phone: (716) 691-7566 fax: (716) 691-9239
website: www.wbacorp.com

Installation procedure: HFG FlameGuard II system
Watson Bowman Acme Corp. reserves the right to amend or withdraw any information contained herein without notice and will not be responsible for any inaccuracy or ambiguity of any information contained herein.



Installation Procedure

Sheet

2
of 4

Watson Bowman Acme Corp.
95 Pineview Drive Amherst, NY 14228
phone: (716) 691-7566 fax: (716) 691-9239
website: www.wbacorp.com

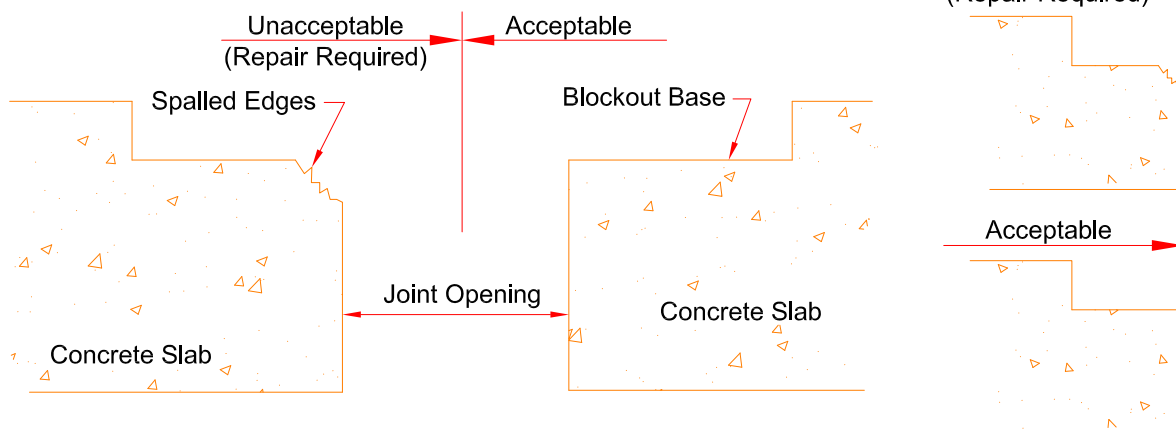

1

Prepare concrete block out for installation of fire barrier. Deficiencies in block out base and spalled edges must be corrected prior to beginning work.

Note: UTILIZING Wabo®Renew, repair corner of concrete slab following manufacturers written instructions. Request Procedure # WBA 4030 or download from WBA's Website.

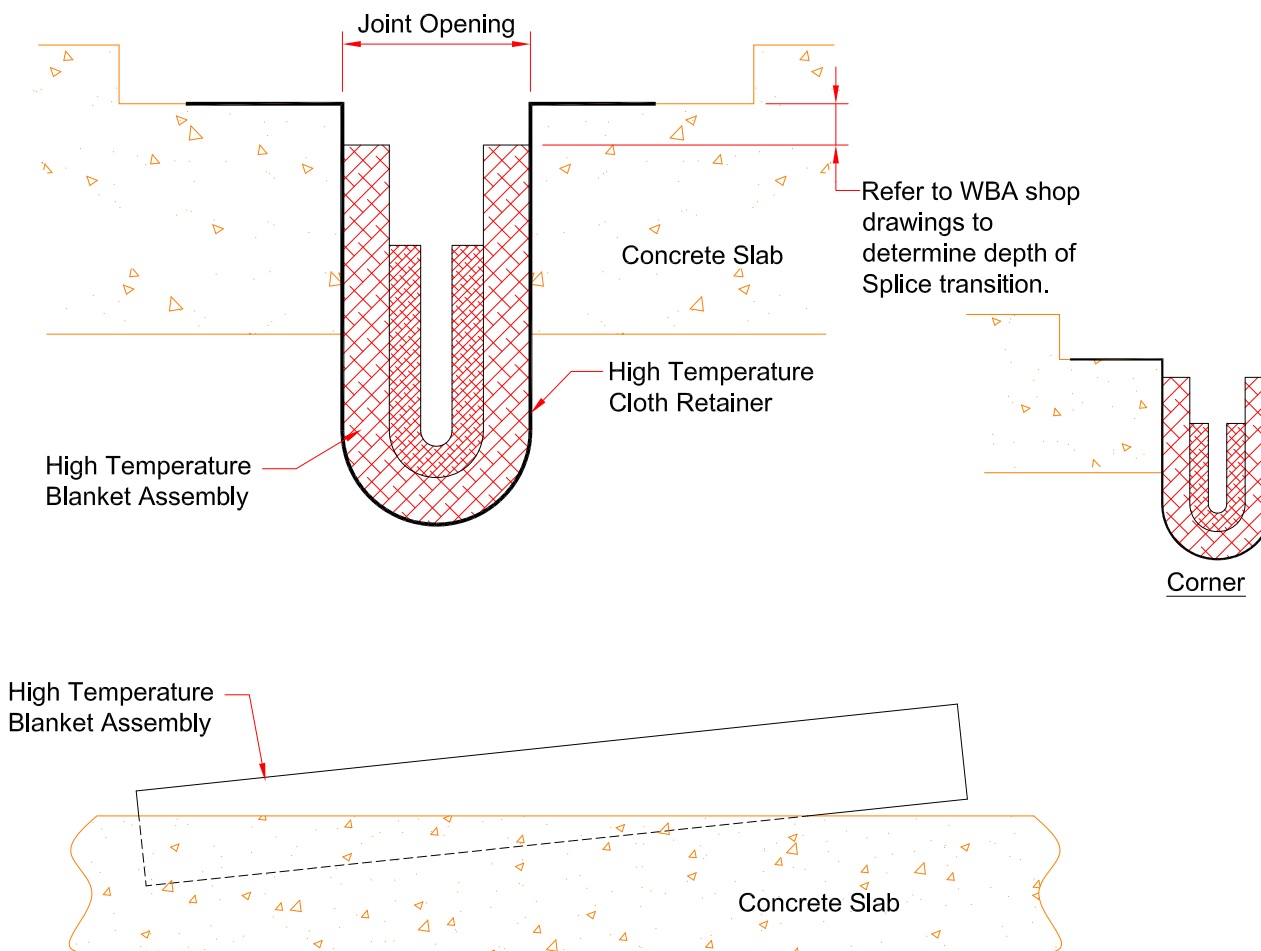

2

Squeeze fire barrier assembly together and slowly insert into joint opening. For easiest installation it is best to start at one end of the fire barrier section and work your way down the section.

Installation procedure: HFG FlameGuard II system

Watson Bowman Acme Corp. reserves the right to amend or withdraw any information contained herein without notice and will not be responsible for any inaccuracy or ambiguity of any information contained herein.



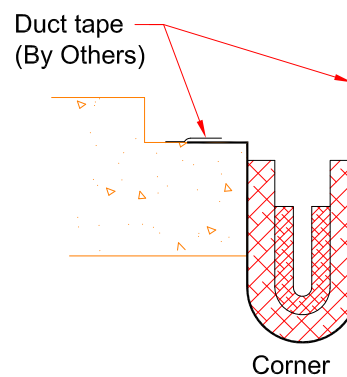
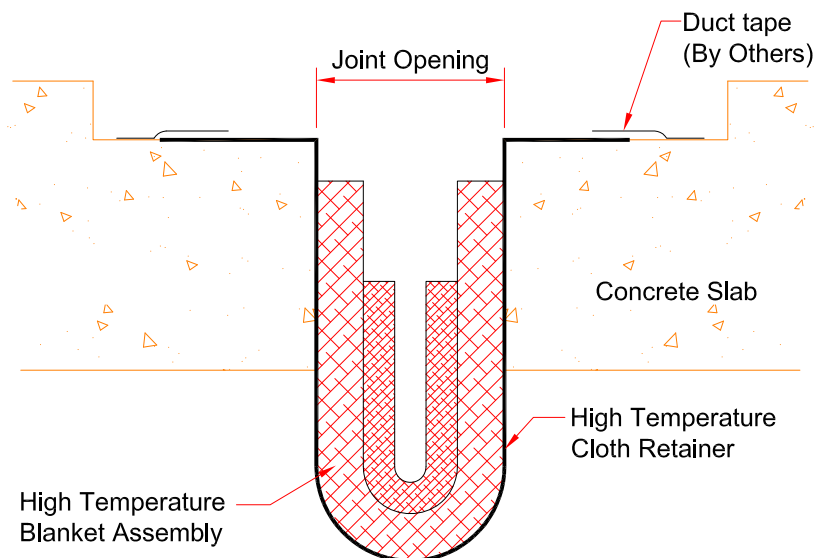

3

Utilizing duct tape as a temporary fastener, tape flaps of high temperature cloth retainer to concrete slab till the fasteners are installed.

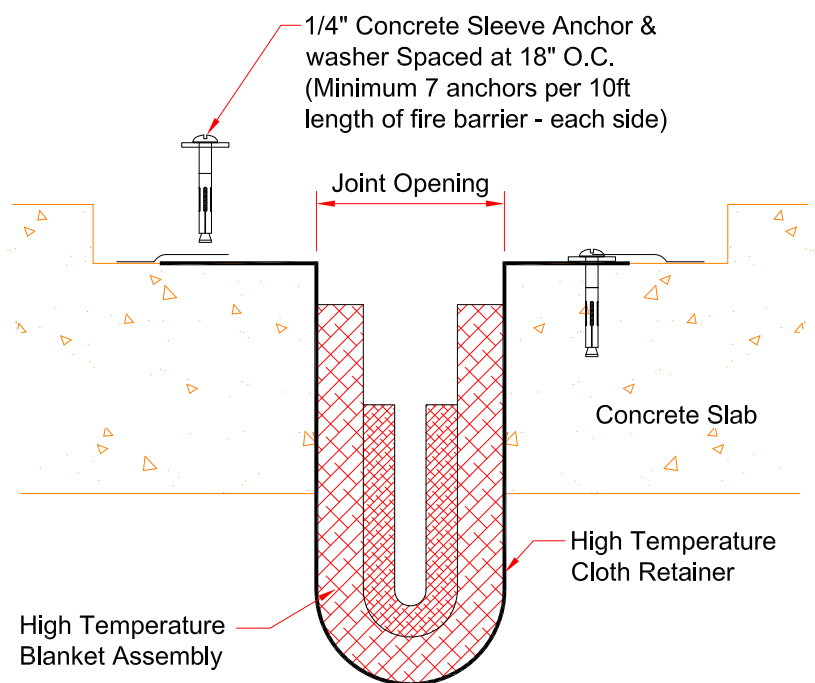

1/4" Concrete Sleeve Anchor & washer Spaced at 18" O.C.
(Minimum 7 anchors per 10ft length of fire barrier - each side)

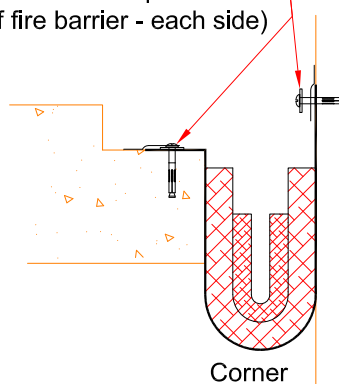

4

Once fire barrier section has been taped down, mark and drill holes for 1/4" x 1 1/2" lg concrete sleeve anchors spaced at 18" O.C. Once the holes have been drilled, remove powder dust exercising care not to get debris into fire blanket assembly. Install concrete sleeve anchor with washers.

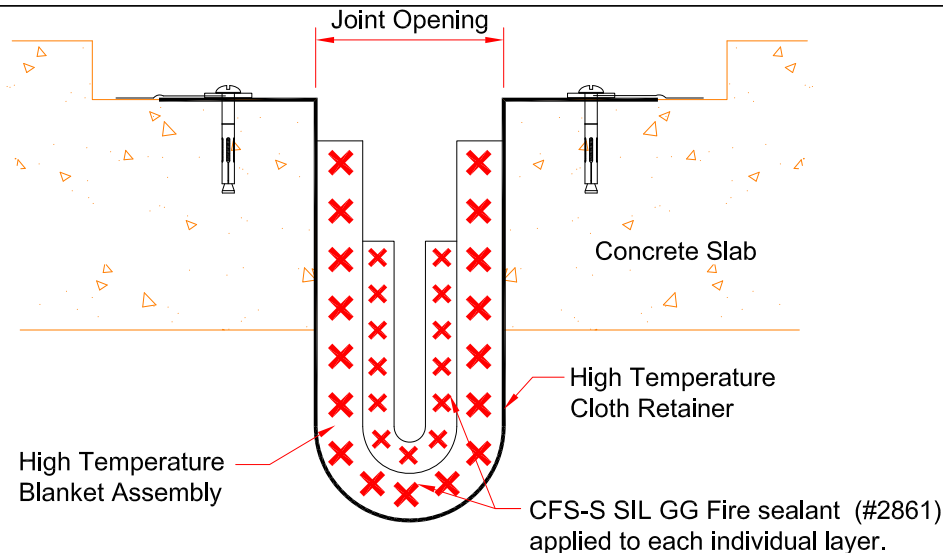

5

After the first section of fire barrier has been installed, apply CFS-S SIL GG sealant (#2861) to all blanket layers of the fire blanket assembly on one side only.

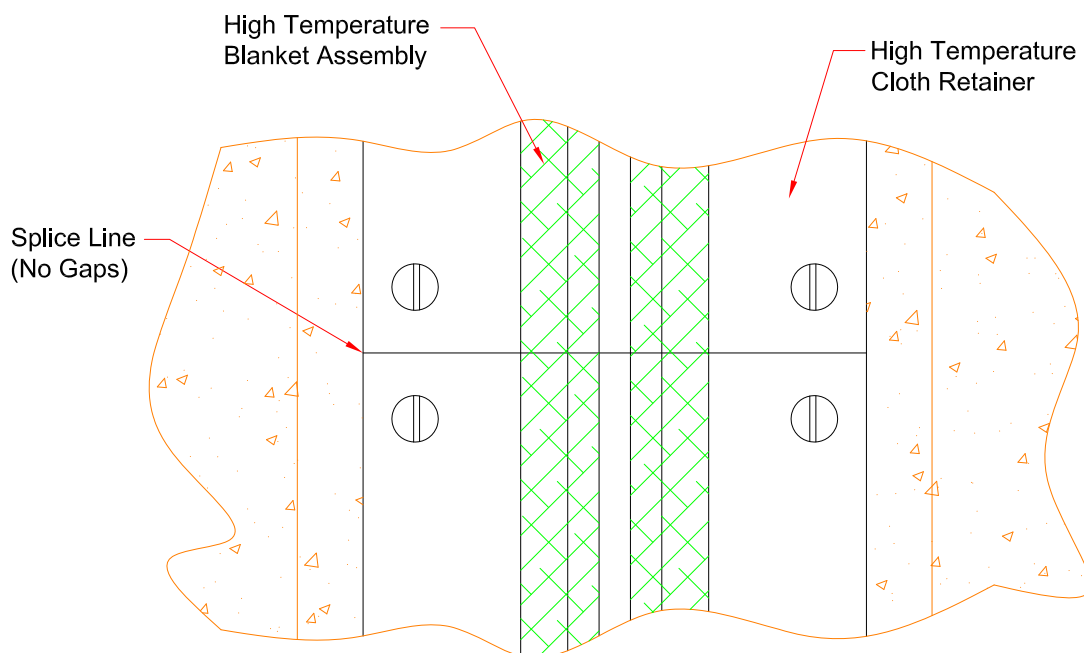

6

Repeat Step 2 with next section of fire barrier. Install next section ensuring that there are no gaps at the splice location between blankets, as shown above.

Note:

To remove small gaps between sections of fire barrier gently pull cloth retainer towards splice line compressing the CFS-S SIL GG sealant (#2861) at the splice line. Exercise care not to damage fire barrier blanket or cloth retainer while pulling it towards splice line.

7

After the next fire barrier section is in place, repeat steps 3 thru 6.

8

With installation complete temporarily cover system to ensure debris does not enter fire barrier cavity. It shall be the installers responsibility to protect completed fire barrier installations. Damaged Fire Barriers will be replaced at installers expense.

Installation procedure: HFG FlameGuard II system

Watson Bowman Acme Corp. reserves the right to amend or withdraw any information contained herein without notice and will not be responsible for any inaccuracy or ambiguity of any information contained herein.

