



Installation Procedure

Watson Bowman Acme Corp. 95 Pineview Drive Amherst, NY 14228

phone: (716) 691-7566 fax: (716) 691-9239

website: www.wbacorp.com

Information provided herein, including but not limited to, any drawing, design, photograph, graphic, or statement(s) ("Materials") are proprietary and the property of Watson Bowman Acme Corporation ("Company"). Reproduction, translation, or reduction to any electronic medium or machine readable form, in whole or part, is strictly prohibited, except for the express purpose for which it has been furnished, without prior written consent of Company. All Materials contained herein are provided by Company for information purposes only. Company reserves the right to amend or withdraw any information contained in the Materials without notice. All technical or other advice by Company, whether verbal or written, concerning products, or the use of products in specific situations ("Advice") is given by Company and is used at the Users own risk.

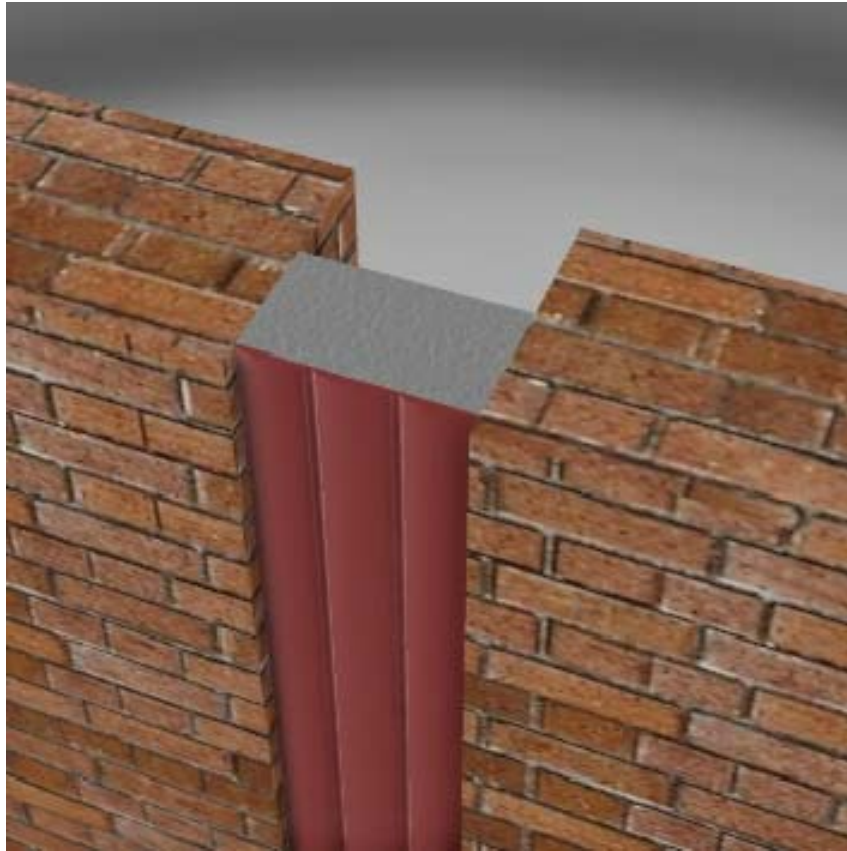

Wabo[®] WeatherSeal II Model(s) "WS" Vertical Expansion Control Systems

The following installation procedure is very important and must be fully understood prior to beginning any work. To ensure proper installation and performance of expansion joint system the following actions must be completed by the installing contractor. Failure to do so will affect product warranty.

- 1) Carefully read and understand installation procedure. Contact WBA's Technical Service Department at (800) 677-4922 for product assistance.
- 2) Inspect all shipments and materials for missing or damaged components and hardware. Contact Customer Service at (800) 677-4922 with WBA's order number and invoice for prompt assistance.
- 3) Inspect substrate or adjacent construction for acceptance before beginning work. Report unacceptable construction to the project manager for scheduled repair work.
- 4) Review WBA shop drawings for project specific detailed information if Engineering services were purchased at time of order.

Standard Components

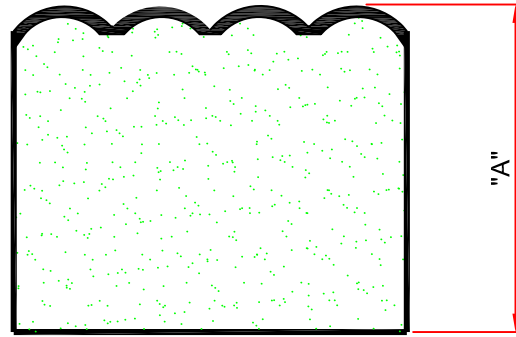

"WS" Seal
(Refer to chart below for
size and part number)

Model	P/n for Colors Below				"A"	Length *
	Precast White	Gray	Charcoal	Natural Stone		
WS-100	10401	10402	10403	10404	1 1/2"	5'
WS-150	10405	10406	10407	10408	2"	5'
WS-200	10409	10410	10411	10412	2"	5'
WS-250	10413	10414	10415	10416	2"	5'
WS-300	10417	10418	10419	10420	2 1/2"	5'
WS-350	10421	10422	10423	10424	2 1/2"	5'
WS-400	10425	10426	10427	10428	2 1/2"	5'
WS-500	10429	10430	10431	10432	4"	5'
WS-600	10441	10442	10443	10444	4"	5'

* - Length shown is approximate. Exact lengths may deviate from length shown.



Color Matched Silicone Sealant
(1 Tube per 40 Lineal Feet)

Components shown below vary in size depending on model of system

Installation procedure: WS WeatherSeal II system

Information provided herein, including but not limited to, any drawing, design, photograph, graphic, or statement(s) ("Materials") are proprietary and the property of Watson Bowman Acme Corporation ("Company"). Reproduction, translation, or reduction to any electronic medium or machine readable form, in whole or part, is strictly prohibited, except for the express purpose for which it has been furnished, without prior written consent of Company. All Materials contained herein are provided by Company for informational purposes only. Company reserves the right to amend or withdraw any information contained in the Materials without notice. All technical or other advice by Company, whether verbal or written, concerning products, or the use of products in specific situations ("Advice") is given by Company and is used at the Users own risk.



Installation Procedure

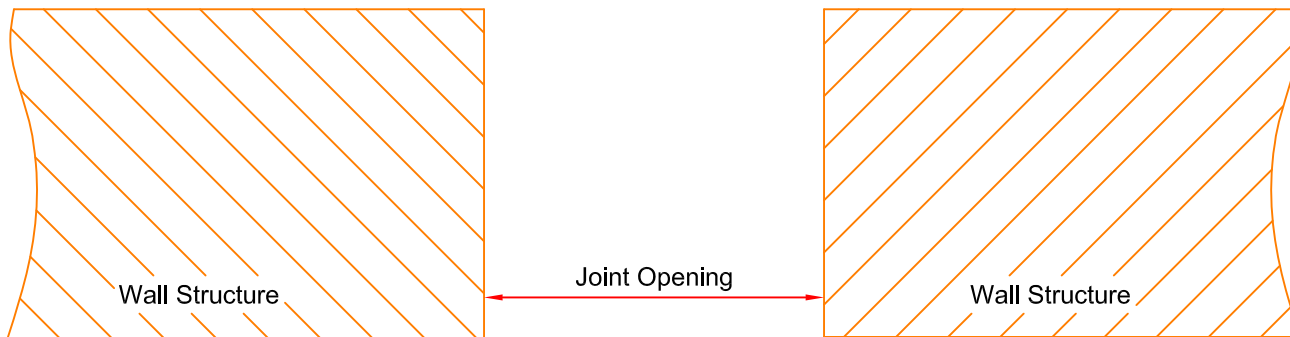

Model	Joint Opening
WS-100	1"
WS-150	1 1/2"
WS-200	2"
WS-250	2 1/2"
WS-300	3"
WS-350	3 1/2"
WS-400	4"
WS-500	5"
WS-600	6"

1 Prior to beginning work, installer shall inspect for proper wall construction and ensure that joint opening has enough depth to accept Wabo®WeatherSeal II. Verify joint opening as called for on chart. Deficiencies in joint opening must be corrected prior to beginning work. Such as spalled edges and protruding objects to ensure a clean, smooth, dry surface for installation of Wabo®Weatherseal II.

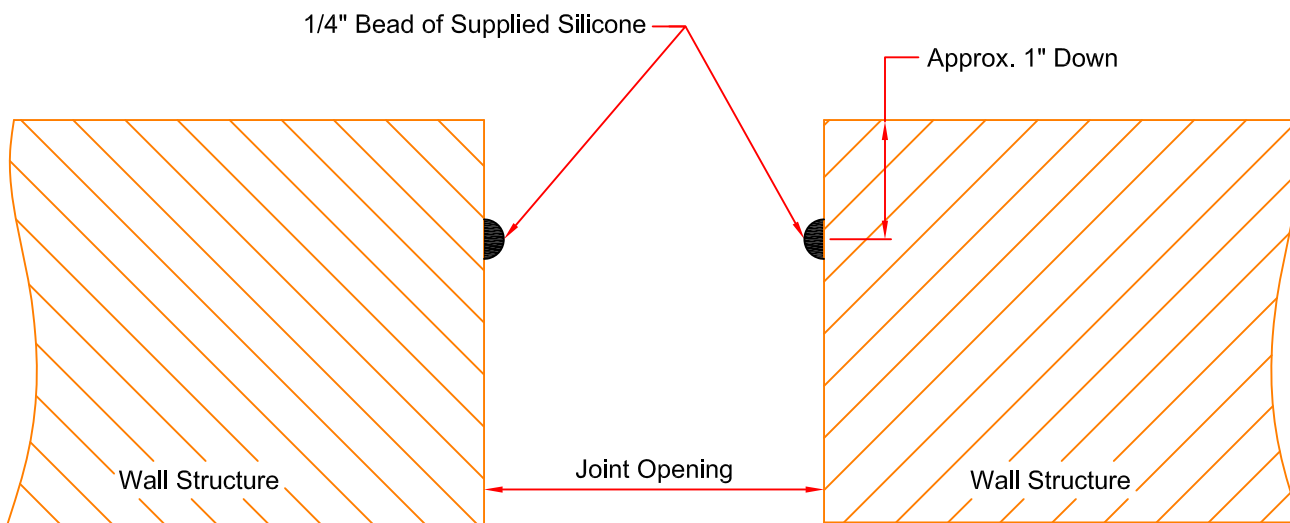

2 Before installation of Wabo®WeatherSeal II, apply a 1/4" bead of Color matched Silicone Sealant on the inside face of the Joint Opening.

Installation procedure: WS WeatherSeal II system

Information provided herein, including but not limited to, any drawing, design, photograph, graphic, or statement(s) ("Materials") are proprietary and the property of Watson Bowman Acme Corporation ("Company"). Reproduction, translation, or reduction to any electronic medium or machine readable form, in whole or part, is strictly prohibited, except for the express purpose for which it has been furnished, without prior written consent of Company. All Materials contained herein are provided by Company for information purposes only. Company reserves the right to amend or withdraw any information contained in the Materials without notice. All technical or other advice by Company, whether verbal or written, concerning products, or the use of products in specific situations ("Advice") is given by Company and is used at the Users own risk.



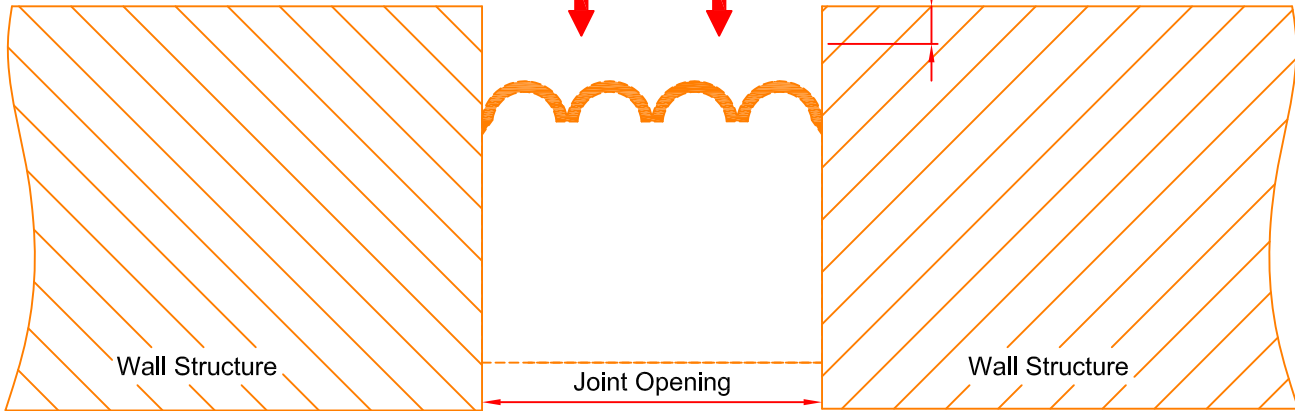
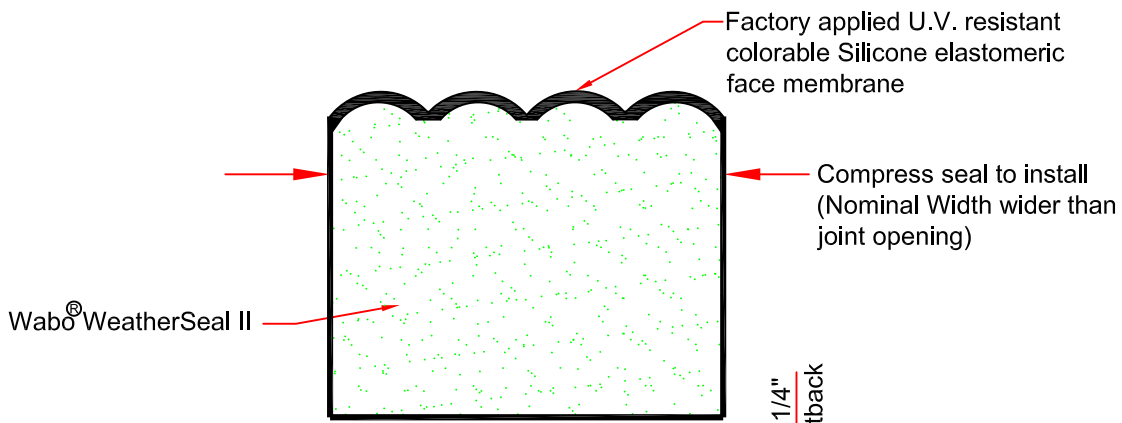

Compress Wabo®WeatherSeal II and push into joint opening with Silicone covering facing outward. Once Seal is normally installed to a correct setback depth of 1/4" from outside face of wall.

3

Note:
Utilizing the supplied color matched Silicone, apply a bead of sealant along inside face of joint opening before installation of Wabo®WeatherSeal II.

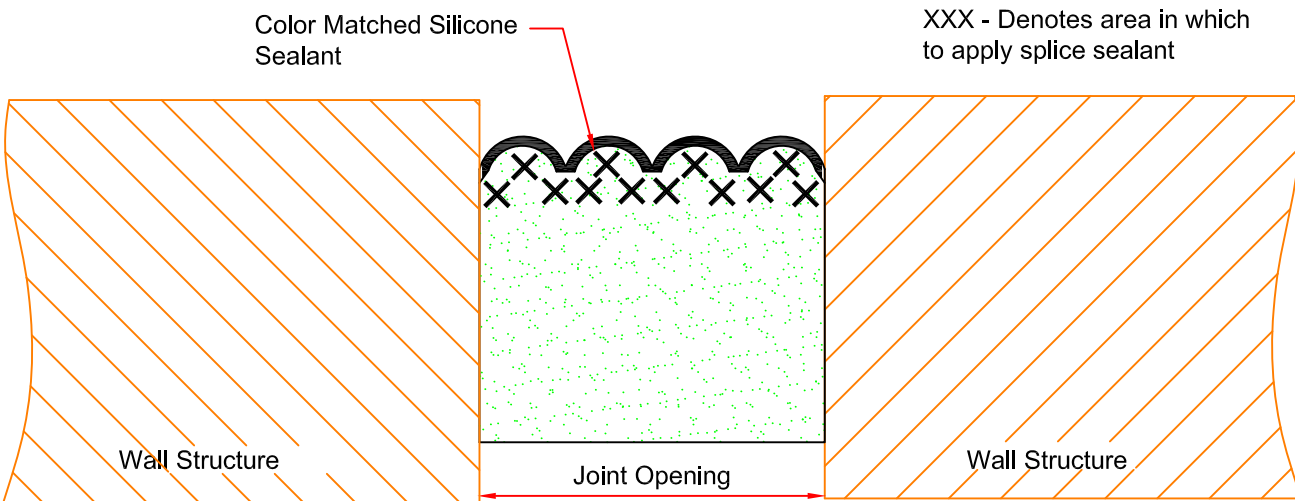

4

Continued on next page...

Installation procedure: WS WeatherSeal II system

Information provided herein, including but not limited to, any drawing, design, photograph, graphic, or statement(s) ("Materials") are proprietary and the property of Watson Bowman Acme Corporation ("Company"). Reproduction, translation, or reduction to any electronic medium or machine readable form, in whole or part, is strictly prohibited, except for the express purpose for which it has been furnished, without prior written consent of Company. All Materials contained herein are provided by Company for information purposes only. Company reserves the right to amend or withdraw any information contained in the Materials without notice. All technical or other advice by Company, whether verbal or written, concerning products, or the use of products in specific situations ("Advice") is given by Company and is used at the Users own risk.



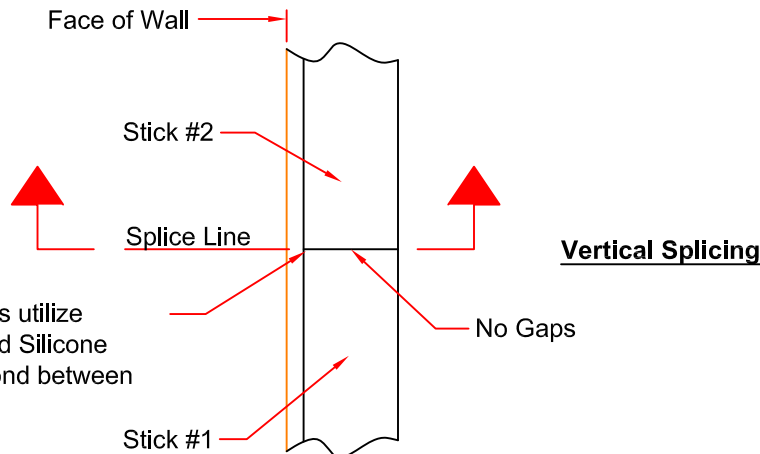

Note: At splice locations utilize Supplied Color Matched Silicone Sealant to provide a bond between seal sticks.

At all splice locations, apply a bead of Color Matched Silicone Sealant at the exposed edge of the Wabo®WeatherSeal II. This is to ensure a proper bond between the factory applied Silicone on each seal stick.

4

Notes:

1. After the Silicone sealant has been installed, repeat installation of Wabo®WeatherSeal II starting from Step 2. Exercise caution so that there are no gaps between each seal stick section during installation.
2. After installation of each stick, tool the splice location smooth using additional supplied silicone if necessary. This will provide a finished surface and hide the splice location as well.

Horizontal Directional Change at Face of Building

Note: At splice locations utilize Supplied Color Matched Silicone Sealant to provide a bond between seal sticks.

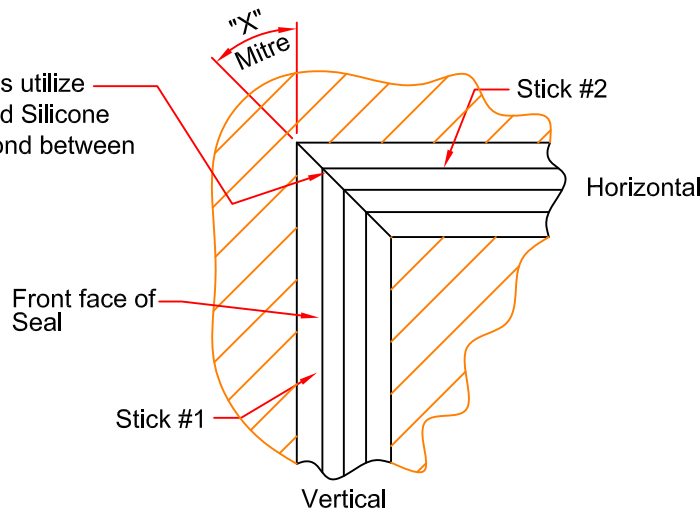

5

At a Horizontal Directional change at face of building, cut Wabo®WeatherSeal II to desired angle of transition.

Note: At directional change locations, follow Step 4 for finishing directions.

Vertical Directional Change at Top of Building wall/Parapet

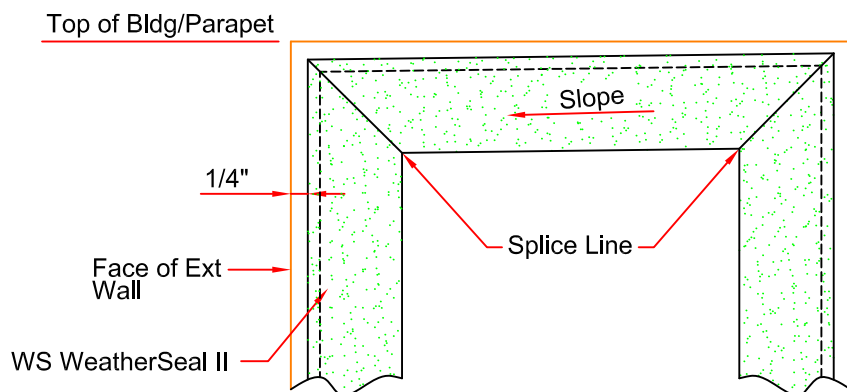

6

At parapet transition locations, cut Wabo®WeatherSeal II to the desired angle of transition.

Note: At directional change locations, follow Step 4 for finishing directions.

Installation procedure: WS WeatherSeal II system

Information provided herein, including but not limited to, any drawing, design, photograph, graphic, or statement(s) ("Materials") are proprietary and the property of Watson Bowman Acme Corporation ("Company"). Reproduction, translation, or reduction to any electronic medium or machine readable form, in whole or part, is strictly prohibited, except for the express purpose for which it has been furnished, without prior written consent of Company. All Materials contained herein are provided by Company for informational purposes only. Company reserves the right to amend or withdraw any information contained in the Materials without notice. All technical or other advice by Company, whether verbal or written, concerning products, or the use of products in specific situations ("Advice") is given by Company and is used at the Users own risk.

