



Installation Procedure

Watson Bowman Acme Corp. 95 Pineview Drive Amherst, NY 14228

phone: (716) 691-7566 fax: (716) 691-9239

website: www.wbcorp.com

Information provided herein, including but not limited to, any drawing, design, photograph, graphic, or statement(s) ("Materials") are proprietary and the property of Watson Bowman Acme Corporation ("Company"). Reproduction, translation, or reduction to any electronic medium or machine readable form, in whole or part, is strictly prohibited, except for the express purpose for which it has been furnished, without prior written consent of Company. All Materials contained herein are provided by Company for information purposes only. Company reserves the right to amend or withdraw any information contained in the Materials without notice. All technical or other advice by Company, whether verbal or written, concerning products, or the use of products in specific situations ("Advice") is given by Company and is used at the Users own risk.

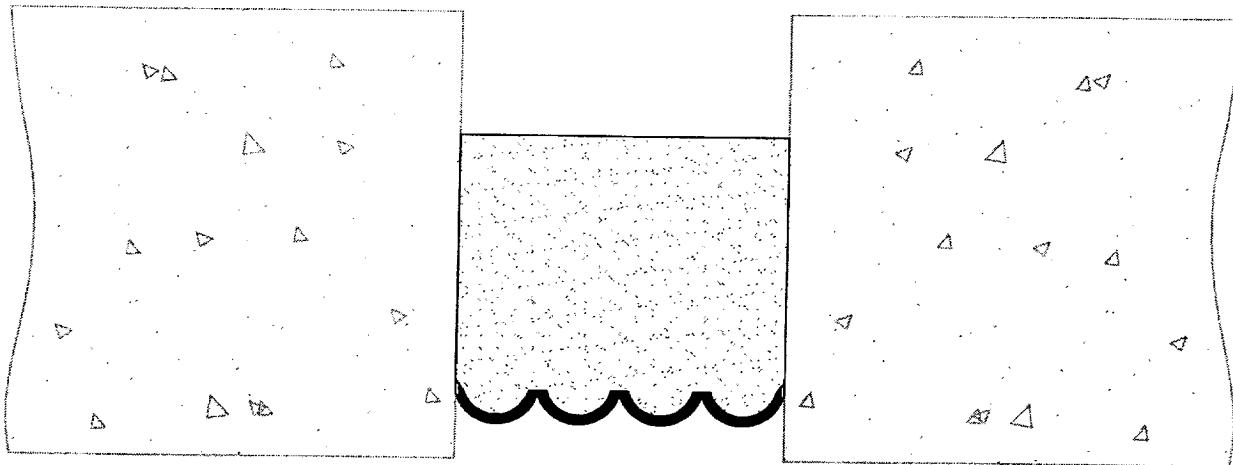

Wabo SeismicWeatherSeal Model(s) "SWS" Vertical Expansion Control Systems

The following installation procedure is very important and must be fully understood prior to beginning any work. To ensure proper installation and performance of expansion joint system the following actions must be completed by the installing contractor. Failure to do so will affect product warranty.

- 1) Carefully read and understand installation procedure. Contact WBA's Technical Service Department at (800) 677-4922 for product assistance.
- 2) Inspect all shipments and materials for missing or damaged components and hardware. Contact Customer Service at (800) 677-4922 with WBA's order number and invoice for prompt assistance.
- 3) Inspect substrate or adjacent construction for acceptance before beginning work. Report unacceptable construction to the project manager for scheduled repair work.
- 4) Review WBA shop drawings for project specific detailed information if Engineering services were purchased at time of order.

Standard Components

Sheet
1
of 5

Watson Bowman Acme Corp.
95 Pineview Drive Amherst, NY 14228
phone: (716) 691-7566 fax: (716) 691-9239
website: www.wbacorp.com

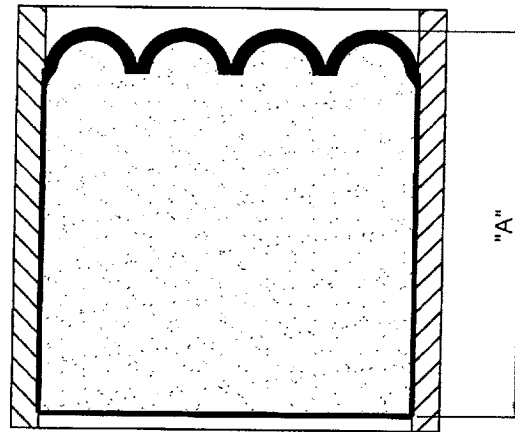

"SWS" Seal
(Refer to chart below for
size and part number)

Model	P/n for Colors Below				"A"	Length
	Precast White	Gray	Charcoal	Natural Stone		
SWS-100	70000	70001	70002	70003	1 1/2"	5'
SWS-150	70004	70005	70006	70007	2"	5'
SWS-200	70008	70009	70010	70011	2"	5'
SWS-250	70012	70013	70014	70015	2"	5'
SWS-300	70016	70017	70018	70019	3"	5'
SWS-350	70020	70021	70022	70023	3"	5'
SWS-400	70024	70025	70026	70027	4"	5'
SWS-500	70028	70029	70030	70031	4"	5'
SWS-600	70032	70030	70034	70035	4"	5'



Color Matched Silicone Sealant
(1 Tube per 40 Lineal Feet)

Components shown below vary in size depending on model
of system

Installation procedure: SWS SeismicWeatherSeal system

Information provided herein, including but not limited to, any drawing, design, photograph, graphic, or statement(s) ("Materials") are proprietary and the property of Watson Bowman Acme Corporation ("Company"). Reproduction, translation, or reduction to any electronic medium or machine readable form, in whole or in part, is strictly prohibited, except for the express purpose for which it has been furnished, without prior written consent of Company. All Materials contained herein are provided by Company for informational purposes only. Company reserves the right to amend or withdraw any information contained in the Materials without notice. All technical or other advice by Company, whether verbal or written, concerning products, or the use of products in specific situations ("Advice") is given by Company and is used at the Users own risk.



Installation Procedure

Sheet

2
of 5

Watson Bowman Acme Corp.
95 Pineview Drive Amherst, NY 14228
phone: (716) 891-7566 fax: (716) 891-9239
website: www.wbacorp.com

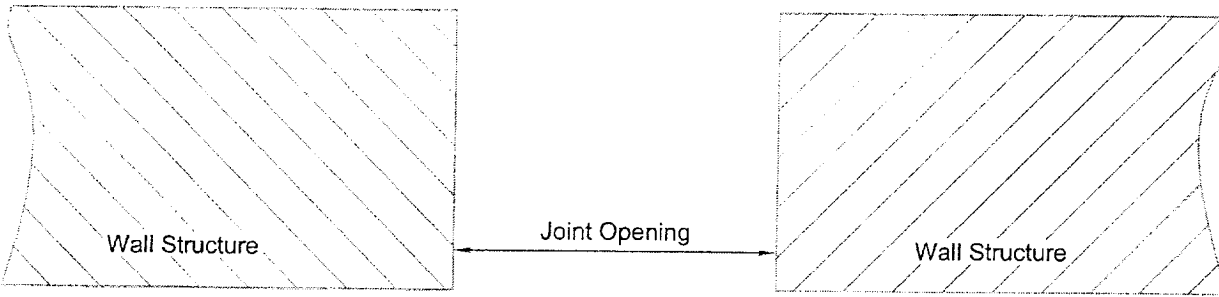

Model	Joint Opening
SWS-100	1"
SWS-150	1 1/2"
SWS-200	2"
SWS-250	2 1/2"
SWS-300	3"
SWS-350	3 1/2"
SWS-400	4"
SWS-500	5"
SWS-600	6"

1

Prior to beginning work, installer shall inspect for proper wall construction and ensure that joint opening has enough depth to accept Wabo®SeismicWeatherSeal and the recommended 1/4" Recess. Verify joint opening as called for on chart. Deficiencies in joint opening must be corrected prior to beginning work. Such as spalled edges and protruding objects to ensure a clean, smooth, dry surface for installation of Wabo®SeismicWeatherseal.

2

Important Note:

Make any cuts to Wabo®SeismicWeatherSeal **before removing** the clear shrink wrap packaging. All starting and ending pieces must be square to the termination point.
For directional changes please refer to Step 7 and Step 8 for instructions.

1/4" Bead of Supplied Silicone

Approx. 1" Down

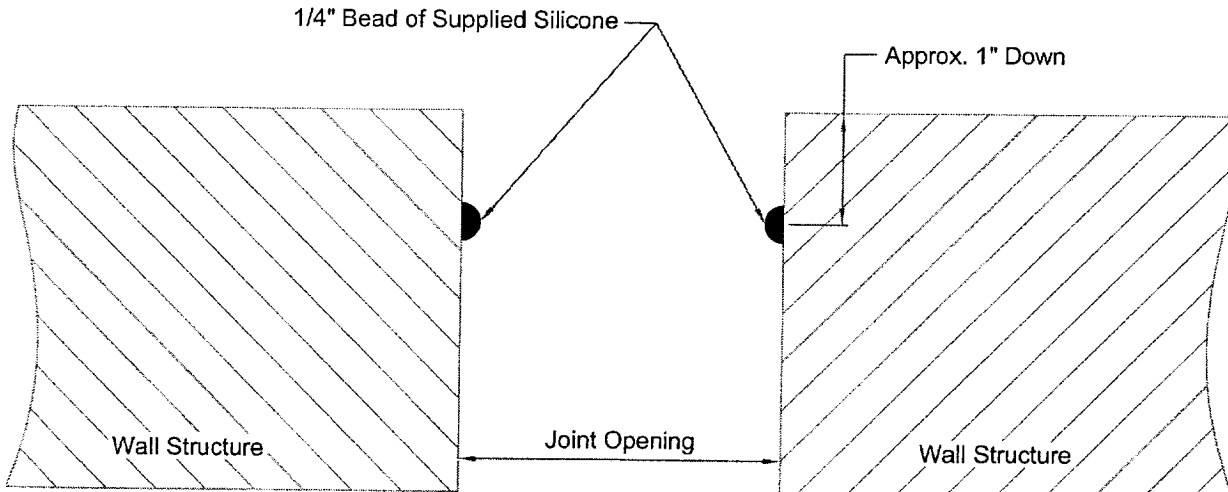

3

Before installation of Wabo®SeismicWeatherSeal, apply a 1/4" bead of Color matched Silicone Sealant on the inside face of the Joint Opening.

Installation procedure: SWS SeismicWeatherSeal system

Information provided herein, including but not limited to, any drawing, design, photograph, graphic, or statement(s) ("Materials") are proprietary and the property of Watson Bowman Acme Corporation ("Company"). Reproduction, translation, or reduction to any electronic form, in whole or part, is strictly prohibited, except for the express purpose for which it has been furnished, without prior written consent of Company. All Materials contained herein are the property of Company and are provided for informational purposes only. Company reserves the right to amend or withdraw any information contained in the Materials without notice. All technical or other advice by Company is given for informational purposes only and is not a warranty. The use of products in specific situations ("Advice") is given by Company and is used at the Users own risk.



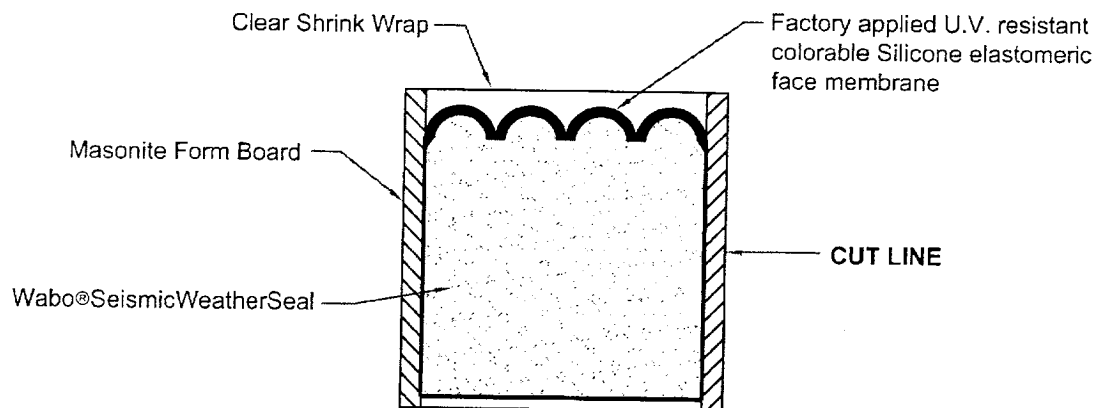

Sheet
3
of 5

Watson Bowman Acme Corp.
95 Pineview Drive Amherst, NY 14228
phone: (716) 691-7566 fax: (716) 691-9239
website: www.wbcorp.com

4

When fully prepared to install Wabo®SeismicWeatherSeal, cut the shrink wrap packaging.

Note:

When removing shrink wrap packaging, cut along Masonite Form. This is to ensure that the colorable Silicone Face has not been cut.

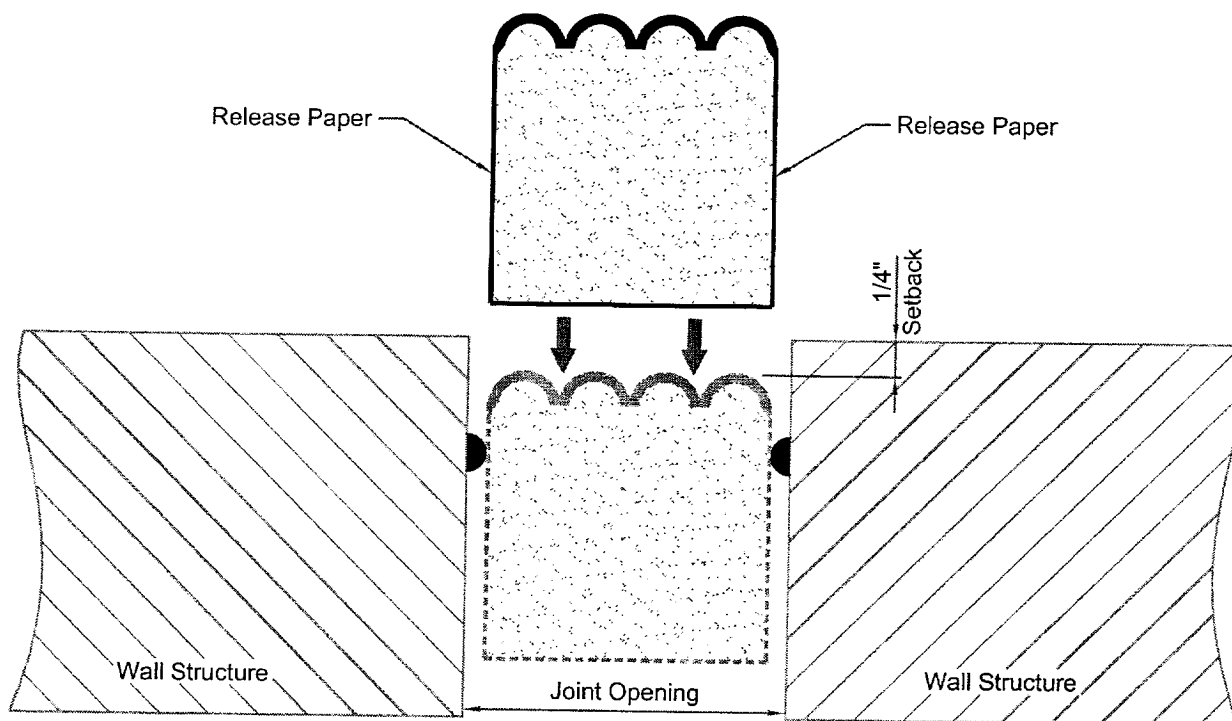

5

After the shrink wrap packaging and masonite forms have been removed, you can start to install the Wabo®SeismicWeatherSeal starting from the bottom to the top so that the seal is recessed 1/4" from the face of the wall. To help activate the pressure sensitive adhesive, use a putty knife to press the seal against the inside face of joint opening.

Note:

If pressure sensitive adhesive is hampering installation, use a spray bottle to wet the adhesive surface of Wabo®SeismicWeatherSeal. This will not impact the final sealing properties.

Installation procedure: SWS SeismicWeatherSeal system

Information provided herein, including but not limited to, any drawing, design, photograph, graphic, or statement(s) ("Materials") are proprietary and the property of Watson Bowman Acme Corporation ("Company"). Reproduction, translation, or reduction to any electronic medium, in whole or in part, is strictly prohibited, except for the express purpose for which it has been furnished, without prior written consent of Company. All Materials contained herein are provided by Company for information purposes only. Company reserves the right to amend or withdraw any information contained in the Materials without notice. All technical or other advice by Company is given in writing, concerning products, or the use of products in specific situations ("Advice") is given by Company and is used at the User's own risk.



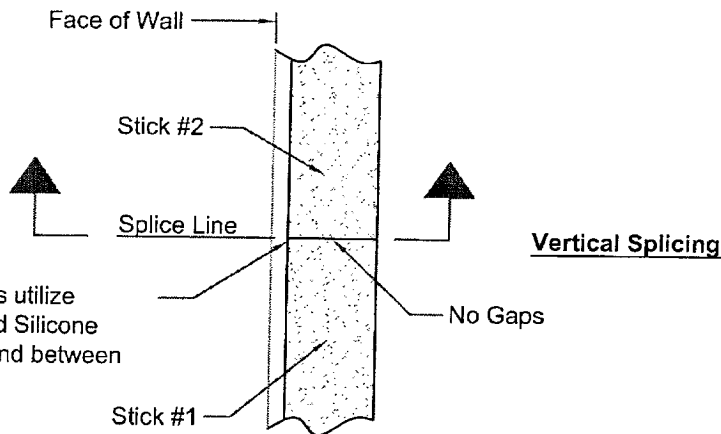
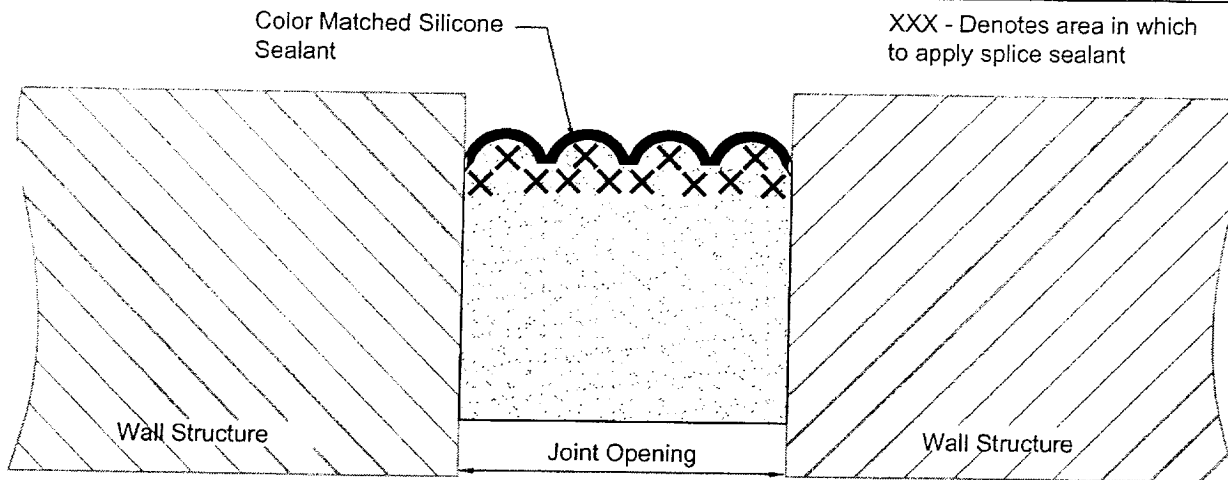

Note: At splice locations utilize Supplied Color Matched Silicone Sealant to provide a bond between seal sticks.

At all splice locations, apply a bead of Color Matched Silicone Sealant at the exposed edge of the Wabo®SeismicWeatherSeal. This is to ensure a proper bond between the factory applied Silicone on each seal stick.

6

Notes:

1. After the Silicone sealant has been installed, repeat installation of Wabo®SeismicWeatherSeal starting from Step 3. Exercise caution so that there are no gaps between each seal stick section during installation.
2. After installation of each stick, tool the splice location smooth using additional supplied silicone if necessary. This will provide a finished surface and hide the splice location as well.

Horizontal Directional Change at Face of Building

Note: At splice locations utilize Supplied Color Matched Silicone Sealant to provide a bond between seal sticks.

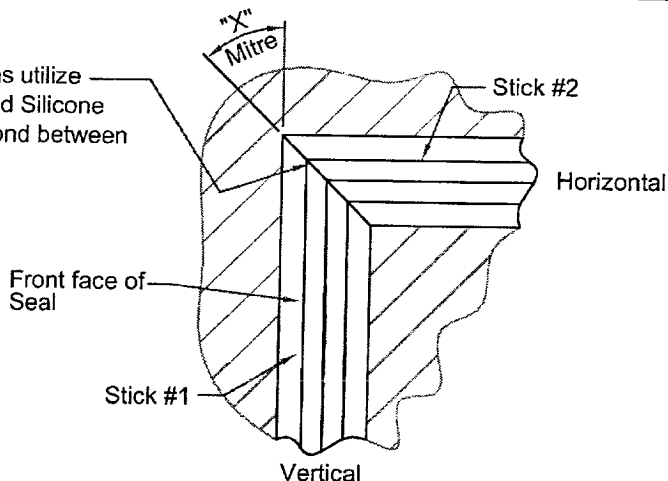

7

At a Horizontal Directional change at face of building, cut Wabo®SeismicWeatherSeal to desired angle of transition.

Note:

Prior to cutting Wabo®SeismicWeatherSeal, make sure not to remove shrink wrap packaging.

Installation procedure: SWS SeismicWeatherSeal system

Information provided herein, including but not limited to, any drawing, design, photograph, graphic, or statement(s) ("Materials") are proprietary and the property of Watson Bowman Acme Corporation ("Company"). Reproduction, translation, or reduction to electronic form or any other form without prior written consent of Company. All Materials are provided by Company for informational purposes only. Company reserves the right to amend or withdraw any information contained in the Materials without notice. All technical or other information is given by Company and is used at the Users own risk.



Vertical Directional Change at Top of Building wall/Parapet

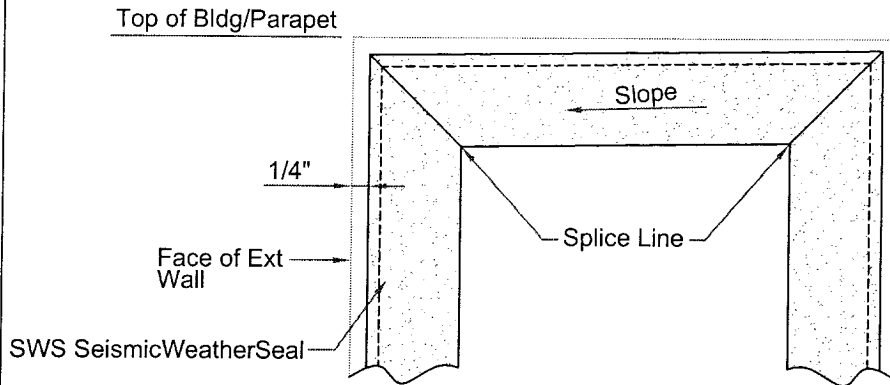

8

At parapet transition locations, cut Wabo®SeismicWeatherSeal to the desired angle of transition.

Note:

Prior to cutting Wabo®SeismicWeatherSeal, make sure not to remove shrink wrap packaging.

9

Tips:

Wabo®SeismicWeatherSeal will expand faster when hot and slower when cold. In cold temperatures, store material in a heated area for 24hrs prior to installation. In hot temperatures, **store material out of direct sunlight and not in an enclosed storage container** where temperatures may exceed 100°F.

Sheet

5
of 5

Watson Bowman Acme Corp.
95 Pineview Drive, Amherst, NY 14228
phone: (716) 691-7566 fax: (716) 691-9239
website: www.wbacorp.com

Installation procedure: SWS SeismicWeatherSeal system

Information provided herein, including but not limited to, any drawing, design, photograph, graphic, or statement(s) ("Materials") are proprietary and the property of Watson Bowman Acme Corporation ("Company"). Reproduction, translation, or reduction to any electronic medium or machine readable form, in whole or part, is strictly prohibited, except for the express purpose for which it has been furnished, without prior written consent of Company. All Materials contained herein are provided by Company for information purposes only. Company reserves the right to amend or withdraw any information contained in the Materials without notice. All technical or other advice by Company, whether verbal or written, concerning products, or the use of products in specific situations ("Advice") is given by Company and is used at the Users own risk.

