

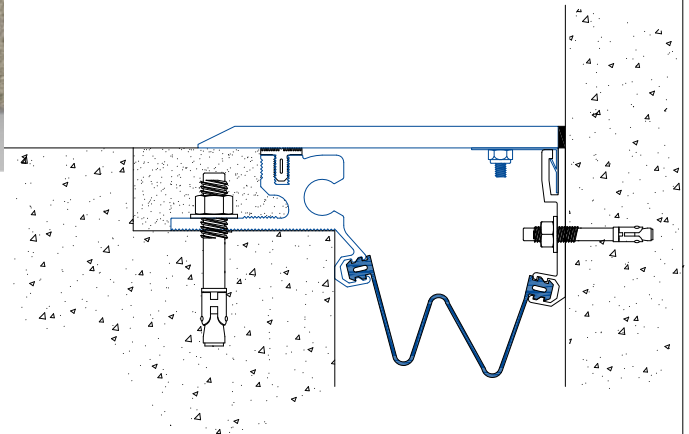

Installation Procedure

Watson Bowman Acme Corp. 95 Pineview Drive Amherst, NY 14228
phone: (716) 691-7566 fax: (716) 691-9239
website: www.wbacorp.com

Information provided herein, including but not limited to, any drawing, design, photograph, graphic, or statement(s) ("Materials") are proprietary and the property of Watson Bowman Acme Corporation ("Company"). Reproduction, translation, or reduction to any electronic medium or machine readable form, in whole or part, is strictly prohibited, except for the express purpose for which it has been furnished, without prior written consent of Company. All Materials contained herein are provided by Company for information purposes only. Company reserves the right to amend or withdraw any information contained in the Materials without notice. All technical or other advice by Company, whether verbal or written, concerning products, or the use of products in specific situations ("Advice") is given by Company and is used at the Users own risk.

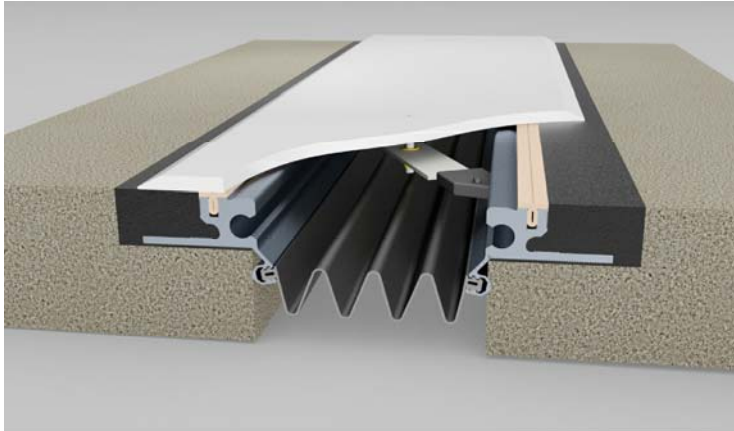

Wabo® SeismicSpan Traffic Series Model(s) "APS" and "APS-C" Horizontal Expansion Control Systems

The following installation procedure is very important and must be fully understood prior to beginning any work. To ensure proper installation and performance of expansion joint system the following actions must be completed by the installing contractor. Failure to do so will affect product warranty.

- 1) Carefully read and understand installation procedure. Contact WBA's Technical Service Department at (800) 677-4922 for product assistance.
- 2) Inspect all shipments and materials for missing or damaged components and hardware. Contact Customer Service at (800) 677-4922 with WBA's order number and invoice for prompt assistance.
- 3) Inspect substrate or adjacent construction for acceptance before beginning work. Report unacceptable construction to the project manager for scheduled repair work.
- 4) Review WBA shop drawings for project specific detailed information if Engineering services were purchased at time of order.

Standard components

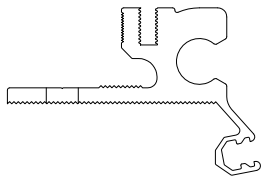

Base member
P/N: 15830

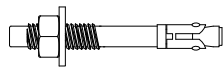

1/4" x 2 1/4" Hilti kwik bolt
P/N: 6581



Vibration gasket
P/N: 15827

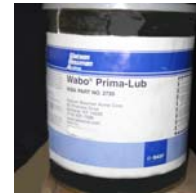

Adhesive Prima-Lub
P/N: 2720



Moisture barrier for
APS-1800 & 1800C
P/N: 2962



1/4" x 1" Self-Tapping Screw
P/N: 5634

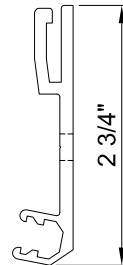

Corner Mount Bracket
P/N: 18044



1/4" Ø Nut
P/N: 7873

(For slip connector only)

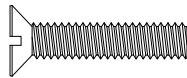

3/8" x 2" Screw
P/N: 5595

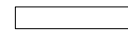

1/4" Ø S.S. Washer
P/N: 7459

(For slip connector only)

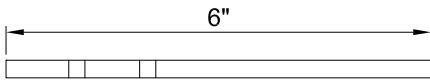

1/4" Splice Bar
P/N: 14050

(Floor-Floor Conditions Only)

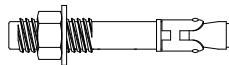

3/8" x 3" Hilti kwik bolt
P/N: 6591



1/4" x 1-1/4" Screw
P/N: 5621

(For slip connector only)

Components shown below vary in size depending on model of system

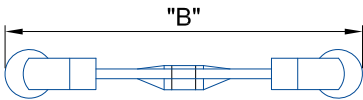

Seismic-Centering bar
(refer to chart for size and P/n)

Model #	P/N	"B" dim.
APS-200	15645	7 3/8"
APS-400	15645	7 3/8"
APS-600	15646	12 3/8"

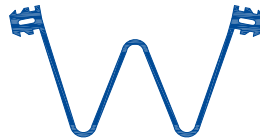

Functional seal
(refer to chart for size and P/n)

Model #	P/N
APS-200/200C	1181
APS-400/400C	1181
APS-600/600C	1175
APS-800/800C	1175
APS-1000/1000C	1176
APS-1200/1200C	1176
APS-1500/1500C	1177

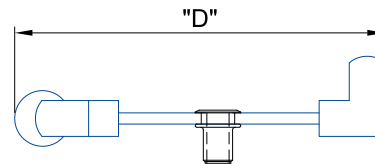

Seismic-Centering bar
(refer to chart for size and P/n)

Model #	P/N	"D" dim.
APS-1000C	15650	12"
APS-1200C	15651	14"
APS-1500C	15652	16"
APS-1800C	15653	19"

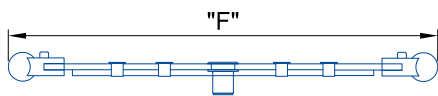

Seismic-Centering bar
(refer to chart for size and P/n)

Model #	P/N	"F" dim.
APS-800	15632	18 3/8"
APS-1000	15632	18 3/8"
APS-1200	15633	22 3/8"
APS-1500	15634	26 3/8"
APS-1800	15667	32 3/8"

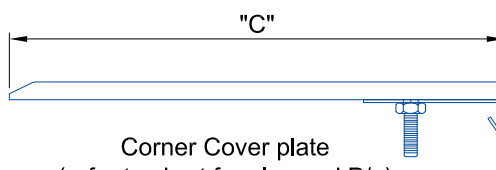

Corner Cover plate
(refer to chart for size and P/n)

Model #	Aluminum P/N	"C" dim.	S.S. P/N
APS-200C	14408	3 3/4"	14424
APS-400C	14409	6 1/4"	14425
APS-600C	14410	8 3/4"	14426
APS-800C	14411	11 1/4"	14427
APS-1000C	14412	13 3/4"	14428
APS-1200C	14413	16 1/4"	14429
APS-1500C	14414	20 1/4"	14430
APS-1800C	14415	23 3/4"	14431

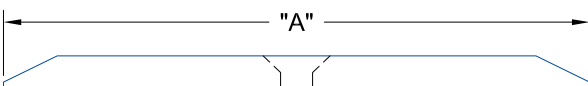

Floor to Floor Cover plate
(refer to chart for size and P/n)

Model #	Aluminum P/N	"A" dim.
APS-200	14400	5 3/4"
APS-400	14401	8 3/4"
APS-600	14402	11 3/4"
APS-800	14403	14 3/4"
APS-1000	14404	17 3/4"
APS-1200	14405	20 3/4"
APS-1500	14406	25 3/4"
APS-1800	14407	29 3/4"

Installation procedure: APS SeismicSpan system
Watson Bowman Acme Corp. reserves the right to amend or withdraw any information contained herein without notice and will not be responsible for any inaccuracy or ambiguity of any information contained herein.



Watson Bowman Acme Corp.
95 Pineview Drive Amherst, NY 14228
phone: (716) 691-7566 fax: (716) 691-9239
website: www.wbacorp.com

Watson Bowman Acme Corp.
95 Pineview Drive Amherst, NY 14228
phone: (716) 691-7566 fax: (716) 691-9239
website: www.wbacorp.com

Installation procedure: APS SeismicSpan system
Watson Bowman Acme Corp. reserves the right to amend or withdraw any information contained herein without notice and will not be responsible for any inaccuracy or ambiguity of any information contained herein.

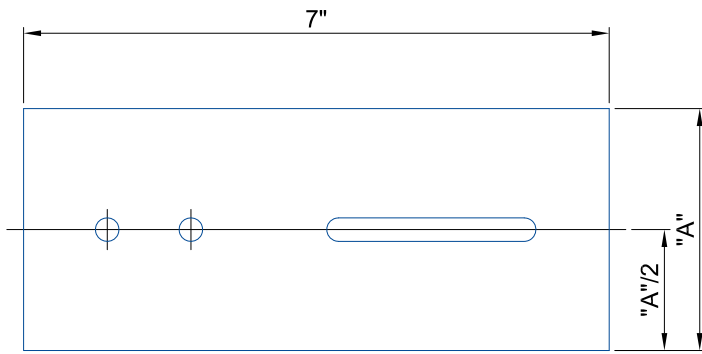

APS Slip Plate Connector
(refer to chart for size and P/n)

Model #	Part Number	"A" dim.
APS-200	14042	4"
APS-400	14043	7"
APS-600	14044	10"
APS-800	14045	13"
APS-1000	14046	16"
APS-1200	14047	19"
APS-1500	14048	24"
APS-1800	14049	28"

Installation Procedure

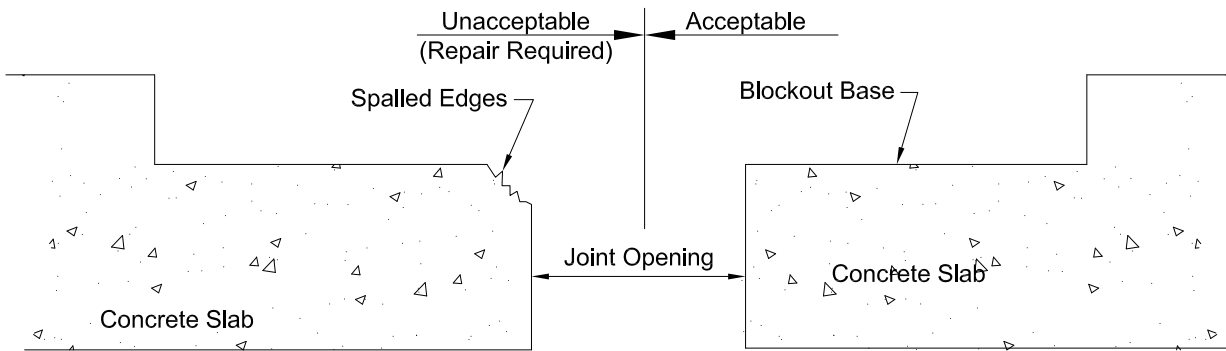

Model #	J.O.	Model #	J.O.
APS-200	2"	APS-1000	10"
APS-400	4"	APS-1200	12"
APS-600	6"	APS-1500	15"
APS-800	8"	APS-1800	18"

1

Prepare concrete block out for installation of Wabo®SeismicSpan Expansion Control System. Deficiencies in block out base and spalled edges must be corrected prior to beginning work.
Note: Utilizing concrete repair material, repair corner of concrete slab following manufacturers written instructions.

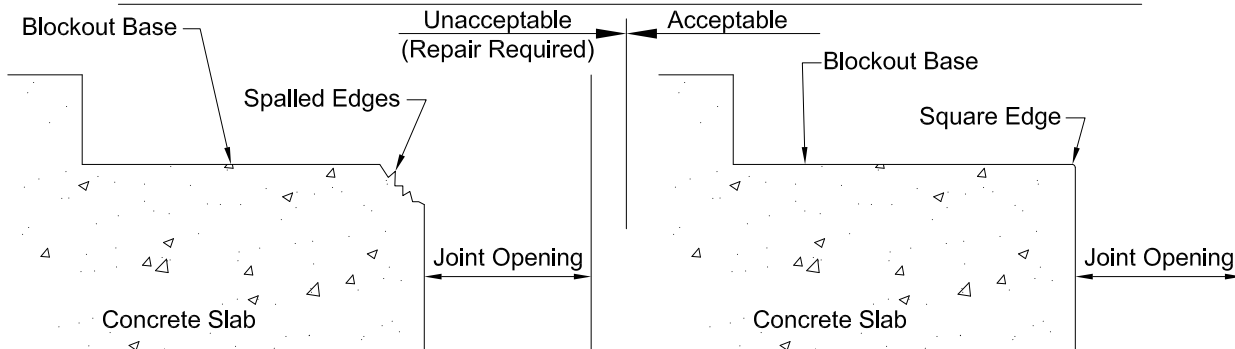

Model #	J.O.	Model #	J.O.
APS-200C	2"	APS-1000C	10"
APS-400C	4"	APS-1200C	12"
APS-600C	6"	APS-1500C	15"
APS-800C	8"	APS-1800C	18"

1A

Corner Condition:
Prepare concrete block out for installation of Wabo®SeismicSpan Expansion Control System. Deficiencies in block out base and spalled edges must be corrected prior to beginning work.
Note: Utilizing concrete repair material, repair corner of concrete slab following manufacturers written instructions.

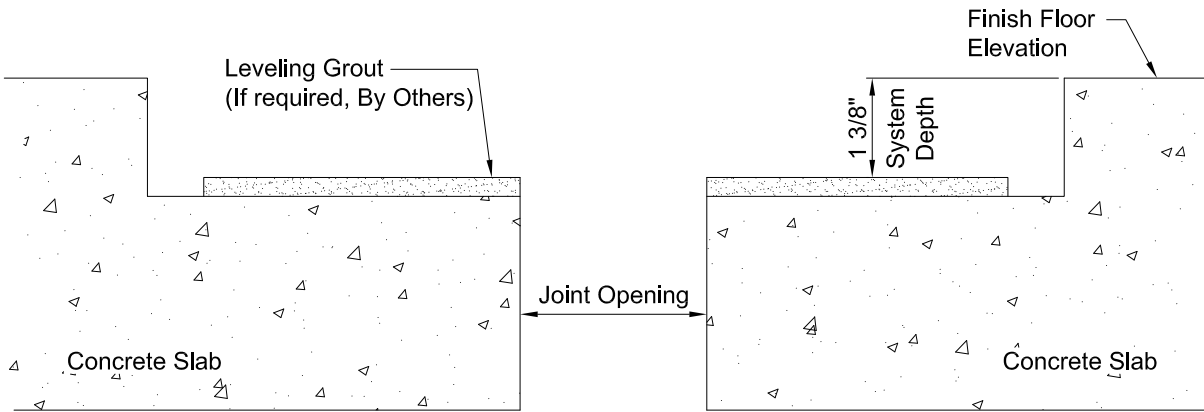

Prepare concrete blockout for installation of expansion joint. Variations in block out dimensions must be corrected prior to beginning work.

2

Note:
 Leveling grout usually not required if blockout was formed true and level to satisfy expansion joint system depth.

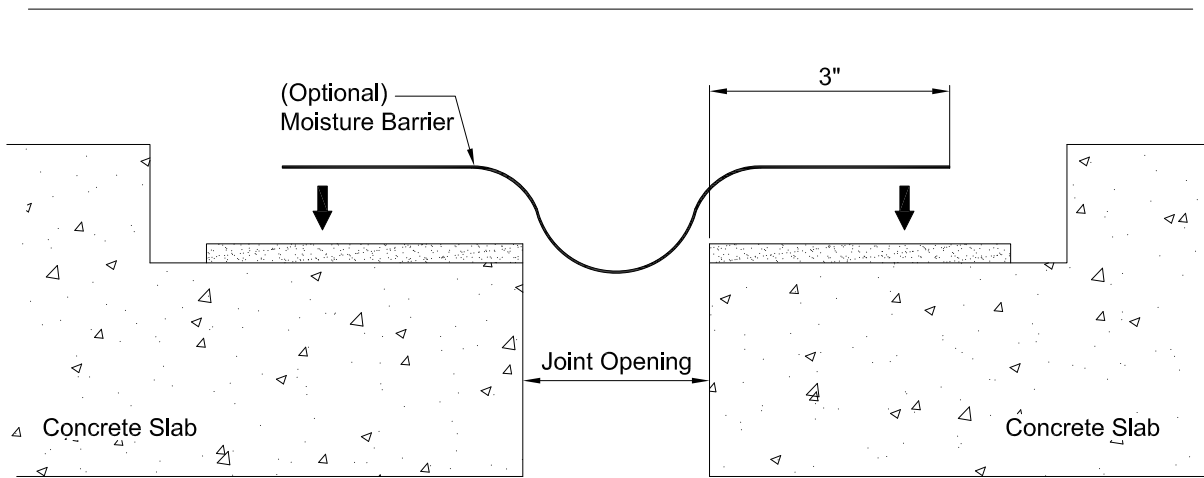

3

(APS-1800 & APS-1800C)
 Install Moisture Barrier. Maintain proper overlap onto blockout base and temporarily affix with Duct Tape.

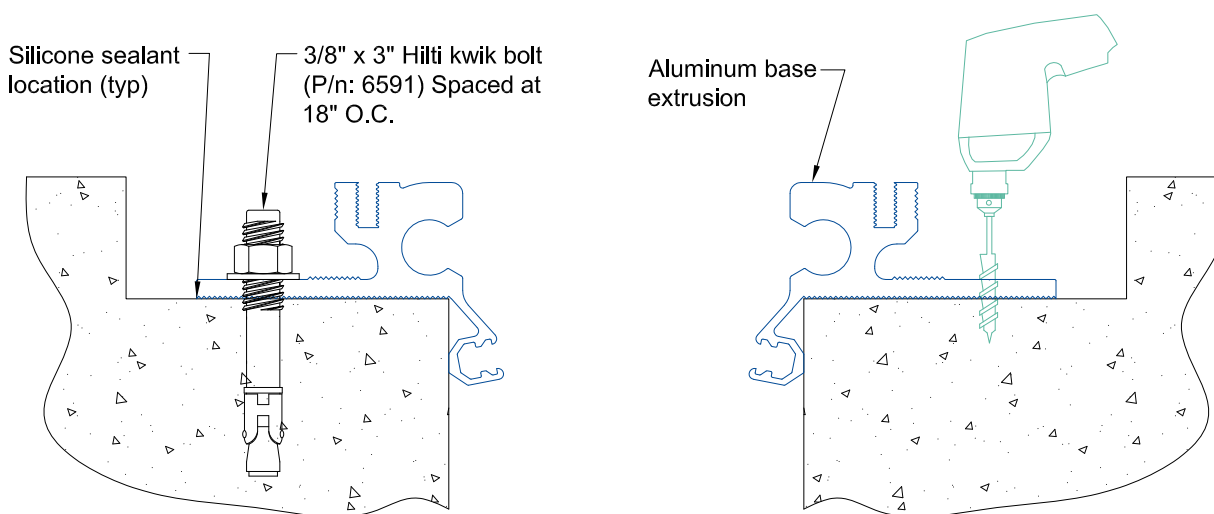

4

Place and adjust aluminum base members into blockouts. Mark anchor locations and follow Hilti recommendations for proper anchor installation. Prior to anchoring base members into place, apply a continuous bead of sealant (by others) onto blockout and at butt ends of aluminum base members. Place and anchor base member.

Installation procedure: APS SeismicSpan system
 Watson Bowman Acme Corp. reserves the right to amend or withdraw any information contained herein without notice and will not be responsible for any inaccuracy or ambiguity of any information contained herein.





Flush with finish floor surface

Aluminum wall mount extrusion

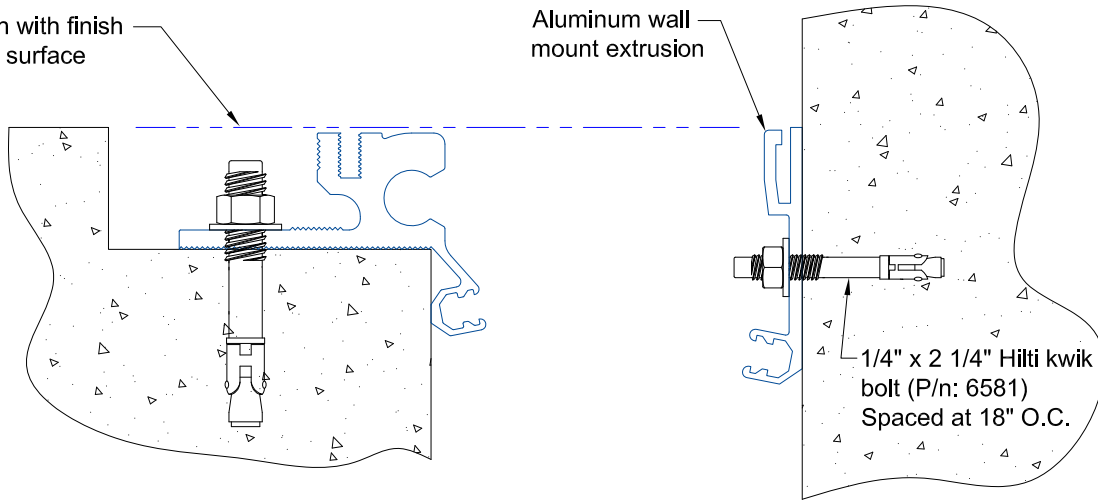

1/4" x 2 1/4" Hilti kwik bolt (P/n: 6581)
Spaced at 18" O.C.

5 Place and adjust aluminum wall mount bracket into blockouts. Mark anchor locations and follow Hilti recommendations for proper anchor installation. Prior to anchoring wall mount brackets into place, apply a continuous bead of sealant (by others) onto blockout and at butt ends of aluminum wall mount brackets. Place and anchor wall mount bracket.

Aluminum base extrusion

Moisture Barrier

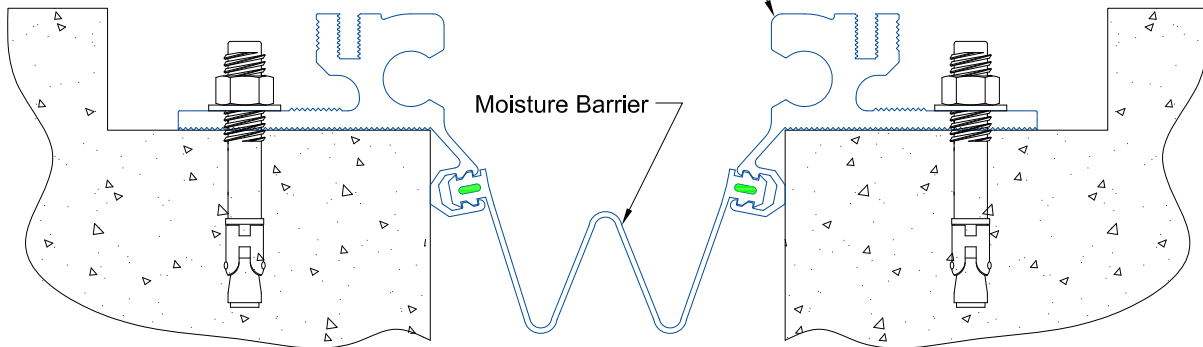

6 Install moisture barrier utilizing supplied Wabo Prima-Lub adhesive.
Note: On custom projects, a sheet good style moisture barrier may be utilized. Refer to Step 3 if applicable

Note: Seismic-Centering bars are to be inserted from one end of the base member.

Seismic-Centering Bars

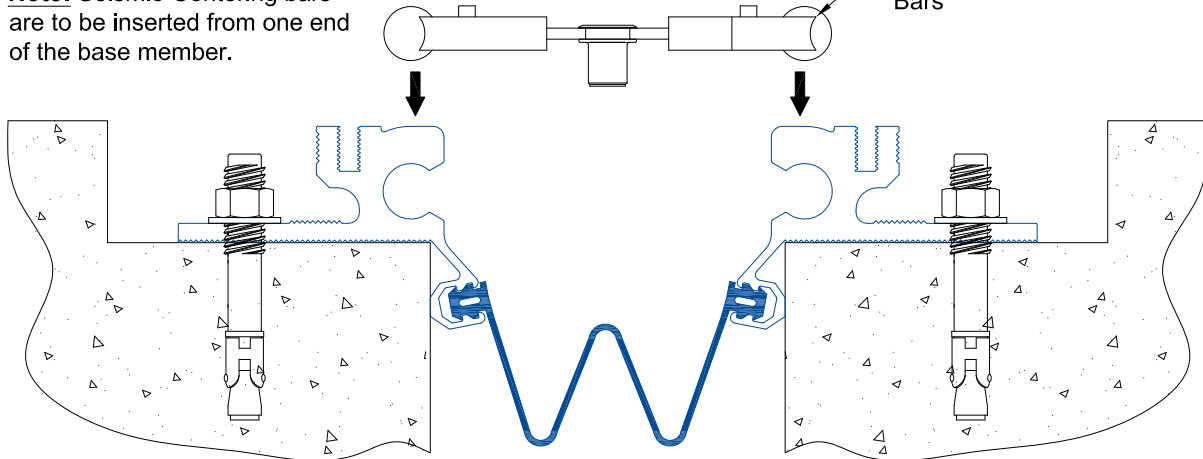

7 As work progresses with placement of base members, install Seismic-centering bars by sliding the sphered ends of the bars into and through the circular cavity of the base members. Set at an approximate spacing of 18" O.C. Ensure that the "TOP" indicator is facing up and that bars are in same orientation.



Wabo®Crete II
Recommended Infill
material) By Others

Tape
(By Others)

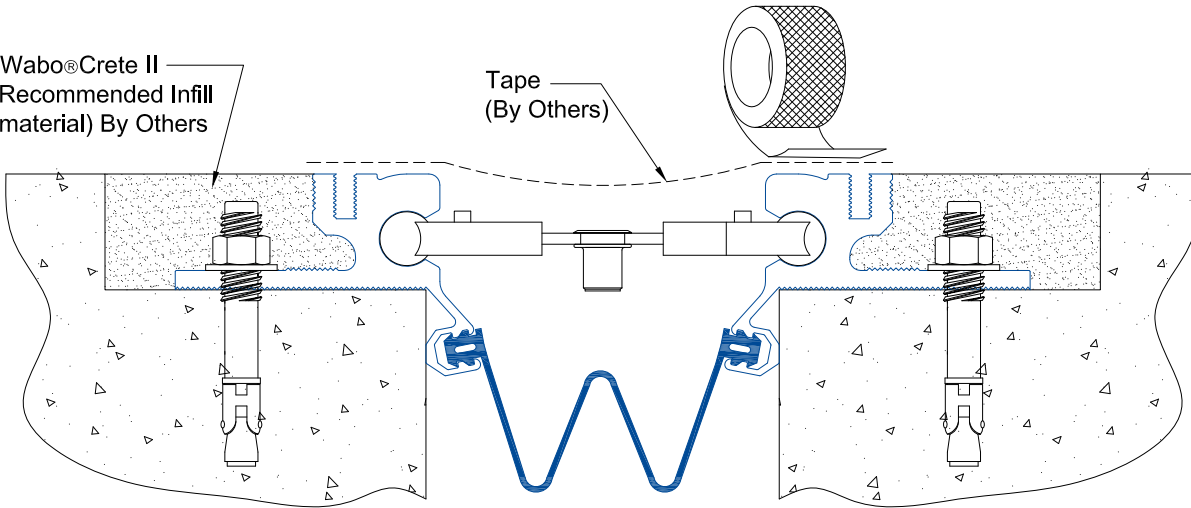

8 Tape and protect exposed metal surfaces during placement of filler material. Fill blockout with Wabo®Crete II or equivalent for infill material. Remove tape immediately after concrete placement.

Rolling Tool
(By Others)

Vibration Gasket

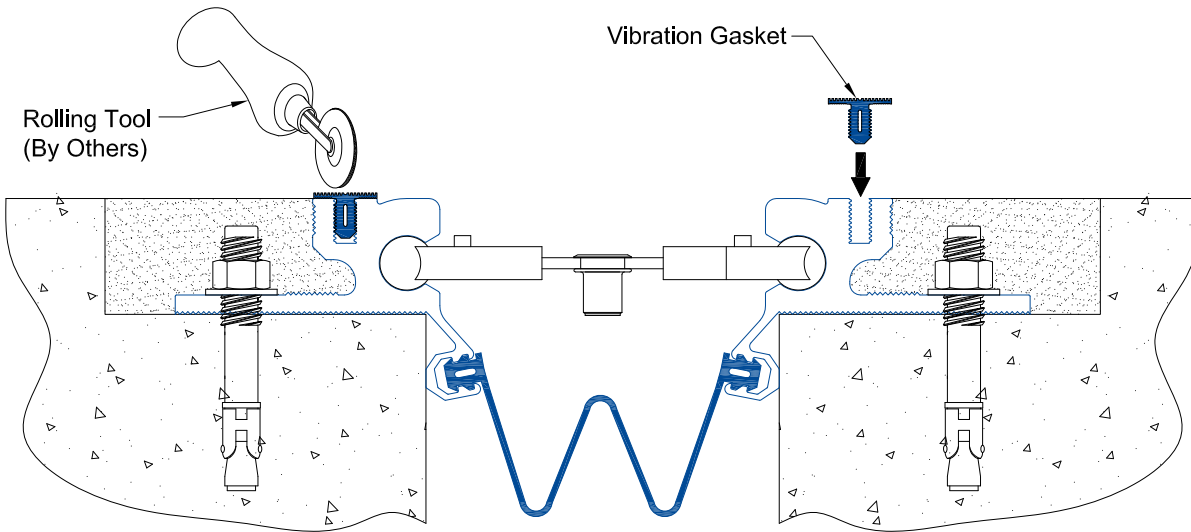

9 Install vibration gaskets utilizing Prima-Lub adhesive provided. Roll gasket to ensure it is fully seated into the aluminum extrusion.

3/8" Dia Screw

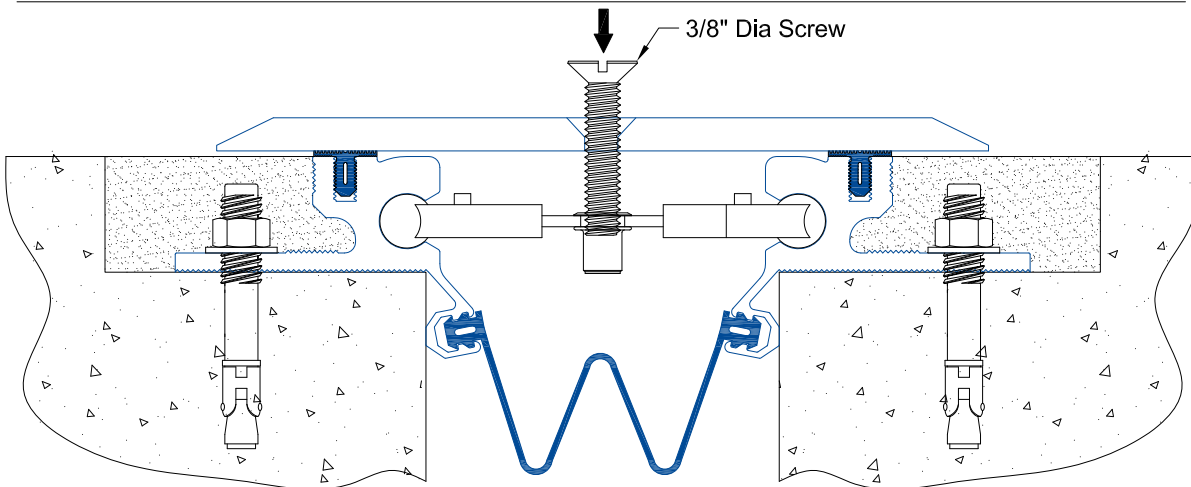

10 Align hole in cover with seismic-centering bar threaded insert. Secure cover plate to the seismic-centering bars with the 3/8" x 2" lg machine screws provided. Do not over tighten.
Note: To assure that threads do not loosen, apply Loctite Thread adhesive to threads of the 3/8" Dia screw before securing cover plate to seismic-centering bars.

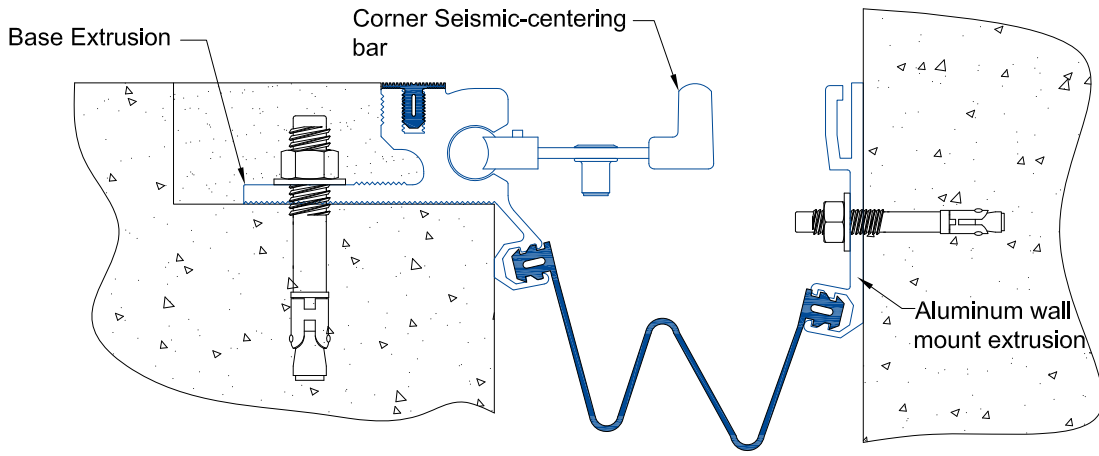

11A **APS-1000C - APS-1800C**
Slide in Corner Seismic-centering Bar into cavity of base extrusion as shown above. Seismic-Centering bar shall be spaced at 18" O.C.

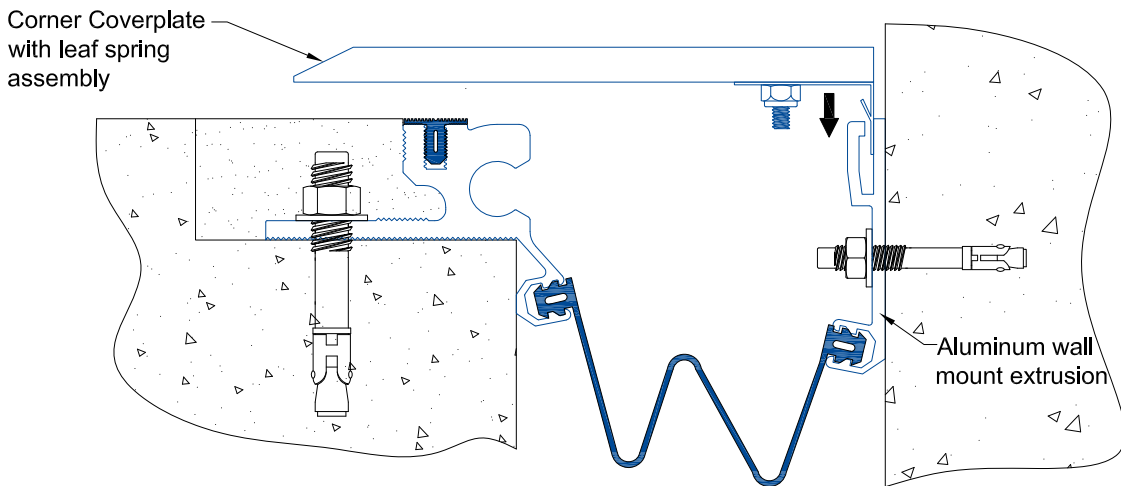

11B **APS-200C - APS-800C**
Insert and snap lock Corner cover plate with leaf spring assembly into Wall Mount Extrusion.

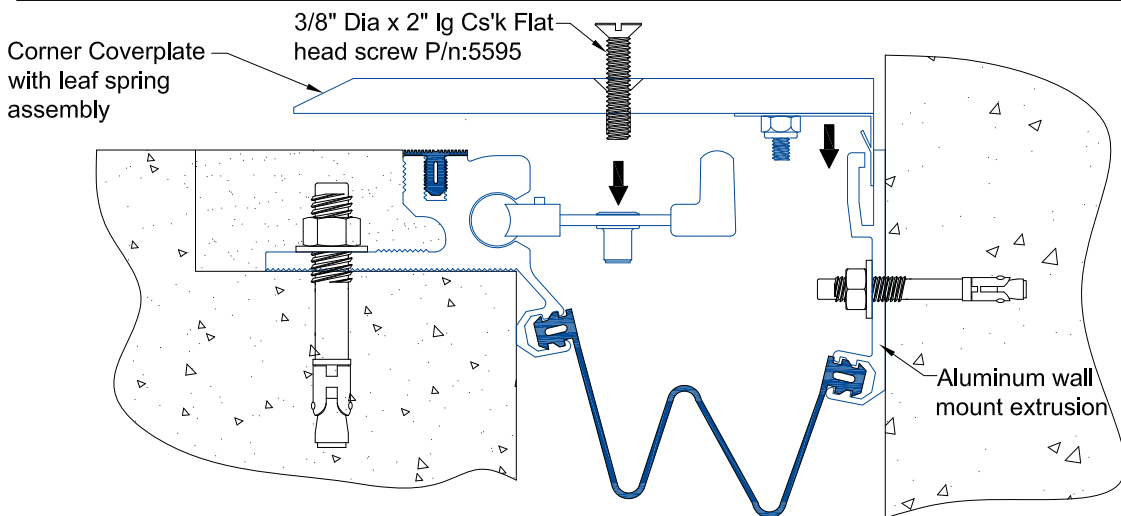

11B **APS-1000C - APS-1800C**
Insert and snap lock Corner cover plate with leaf spring assembly into Wall Mount Extrusion. Align pre-drilled holes in slide plate with threaded insert in Seismic-Centering bars. Secure with 3/8" x 2" csk Flathead screws. Tighten to create measurable tension in the bar. Do not overtighten.
Note: To assure that threads do not loosen, apply Loctite Thread adhesive to threads of the 3/8" Dia screw before securing cover plate to seismic-centering bars.

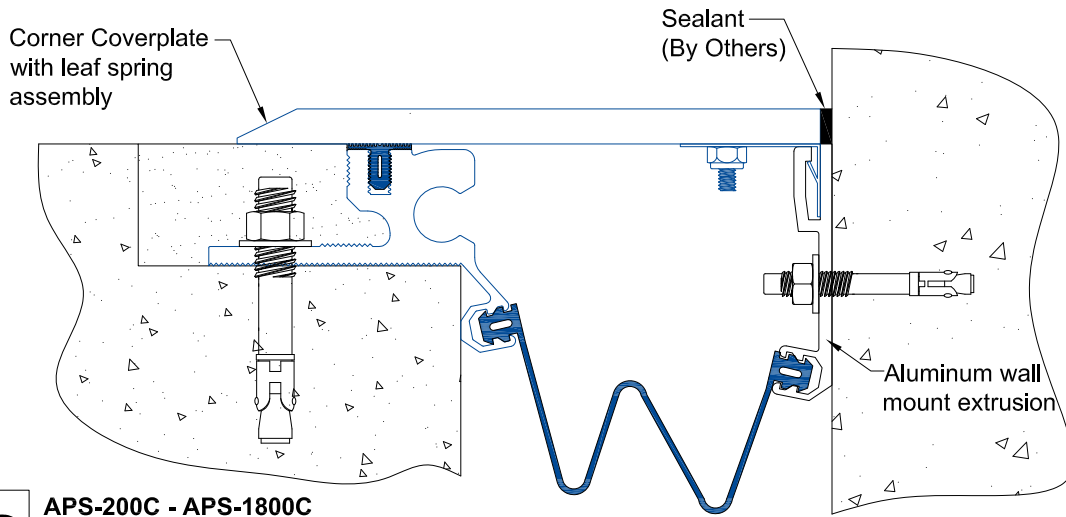

11C

APS-200C - APS-1800C

After Corner cover plate has been installed, apply a bead of sealant (By Others) along wall and edge of cover plate as shown above.

Floor to Floor Conditions Only

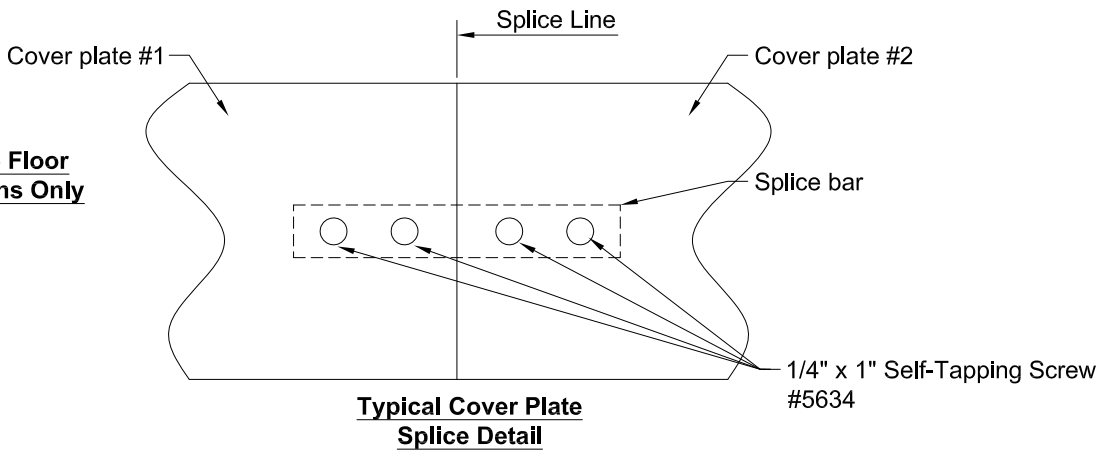

12

At cover plate splice line attach one side of splice bar to the bottom side of cover plate with 1/4" x 1" screws. After one side has been fastened, field match drill holes in splice bar utilizing a .228" dia drill bit allowing the cover plate as a template. After splice bar has been field drilled, install 1/4" x 1" screws to fasten splice bar to cover plate.

Floor to Floor Conditions Only

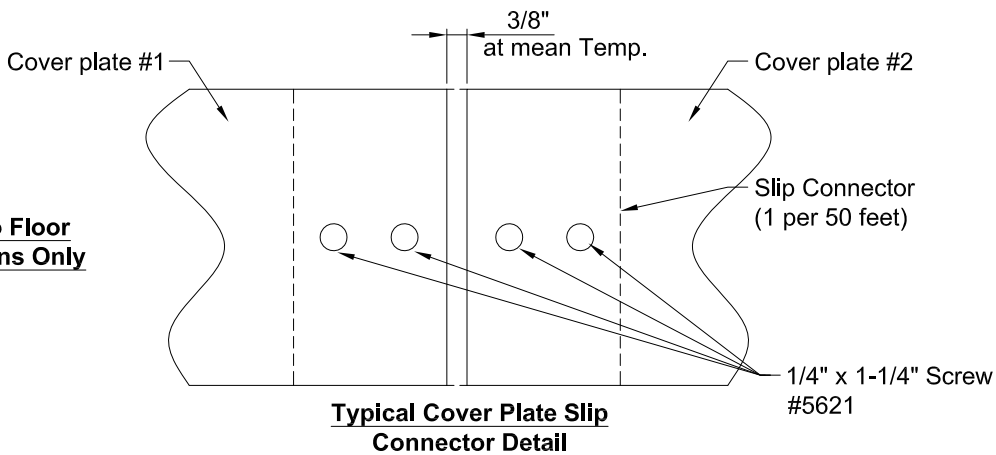

12A

At every 50 ft splice line location, attach one side of slip connector to the bottom side of cover plate with 1/4" x 1-1/4" screws. After one side has been fastened, using 1/4" x 1-1/4" screws fasten cover plate into slip connector through the holes already pre drilled in coverplate.

Installation procedure: APS SeismicSpan system
Watson Bowman Acme Corp. reserves the right to amend or withdraw any information contained herein without notice and will not be responsible for any inaccuracy or ambiguity of any information contained herein.

