

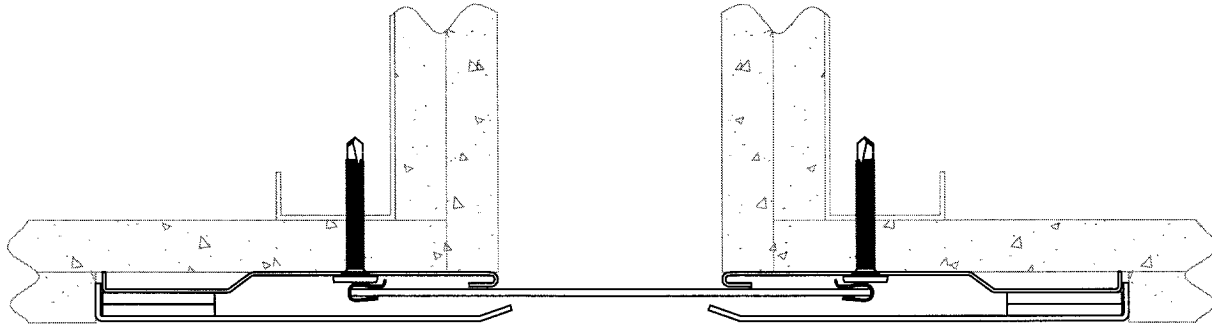

Installation Procedure

Watson Bowman Acme Corp. 95 Pineview Drive Amherst, NY 14228
phone: (716) 691-7566 fax: (716) 691-9239
website: www.wbacorp.com

Watson Bowman Acme Corp. reserves the right to amend or withdraw any information contained herein without notice and will not be responsible or liable for any inaccuracy or ambiguity of any information contained herein.



Wabo® Contour - Professional Series Model(s) "CTR" 800-2400 Vertical Expansion Control Systems

The following installation procedure is very important and must be fully understood prior to beginning any work. To ensure proper installation and performance of expansion joint system the following actions must be completed by the installing contractor. Failure to do so will affect product warranty.

- 1) Carefully read and understand installation procedure. Contact WBA's Technical Service Department at (800) 677-4922 for product assistance.
- 2) Inspect all shipments and materials for missing or damaged components and hardware. Contact Customer Service at (800) 677-4922 with WBA's order number and invoice for prompt assistance.
- 3) Inspect substrate or adjacent construction for acceptance before beginning work. Report unacceptable construction to the project manager for scheduled repair work.
- 4) Review WBA shop drawings for project specific detailed information if Engineering services were purchased at time of order.

Standard Components

Sheet

1

of 3



#10-24 x 1 1/2"
Pancake Head Screw
P/N: 5744



Tinnerman Clips
P/N: 8448

Components shown below vary in size depending on model of system

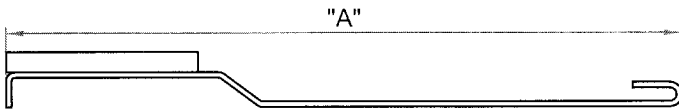

Galvanized Steel Lower Edge Component
(Refer to Chart for size and P/N's)

Model	"A"	P/n
CTR-800	6 1/4"	11836
CTR-1000	7 1/4"	11837
CTR-1200	8 1/4"	11838
CTR-1800	11 1/4"	11839
CTR-2400	14 1/4"	11840

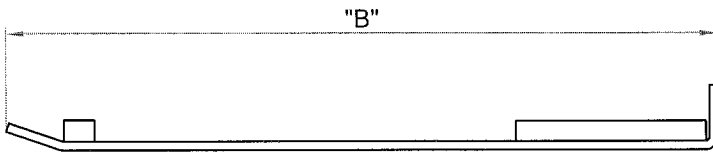

Upper Edge Component
(Refer to Chart for size and P/N's)

Model	"B"	P/n
CTR-800	6 5/8"	11820
CTR-1000	7 5/8"	11821
CTR-1200	8 5/8"	11822
CTR-1800	11 5/8"	11823
CTR-2400	14 5/8"	11824

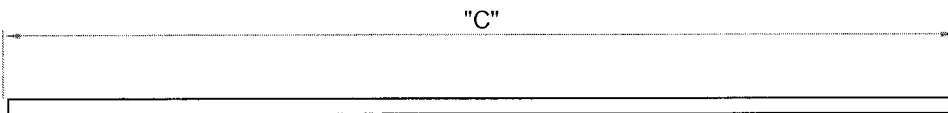

Slide Plate
(Refer to Chart for size and P/N's)

Model	"C"	P/n
CTR-800	14"	11804
CTR-1000	17"	11805
CTR-1200	20"	11806
CTR-1800	29"	11807
CTR-2400	38"	11808

Watson Bowman Acme Corp.
95 Pineview Drive Amherst, NY 14228
phone: (716) 691-7566 fax: (716) 691-9239
website: www.wbcorp.com

Installation procedure: CTR 800-2400 Contour
Watson Bowman Acme Corp. reserves the right to amend or withdraw any information contained herein without notice and will not be responsible for any inaccuracy or ambiguity of any information contained herein.

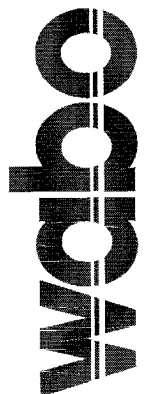

Installation Procedure

Sheet

2
of 3

Watson Bowman Acme Corp.
95 Pineview Drive Amherst, NY 14228
phone: (716) 691-7566 fax: (716) 691-9239
website: www.wbcorp.com

Installation procedure: CTR 800-2400 Contour
Watson Bowman Acme Corp. reserves the right to amend or withdraw any information contained herein without notice and will not be responsible for any inaccuracy or ambiguity of any information contained herein.

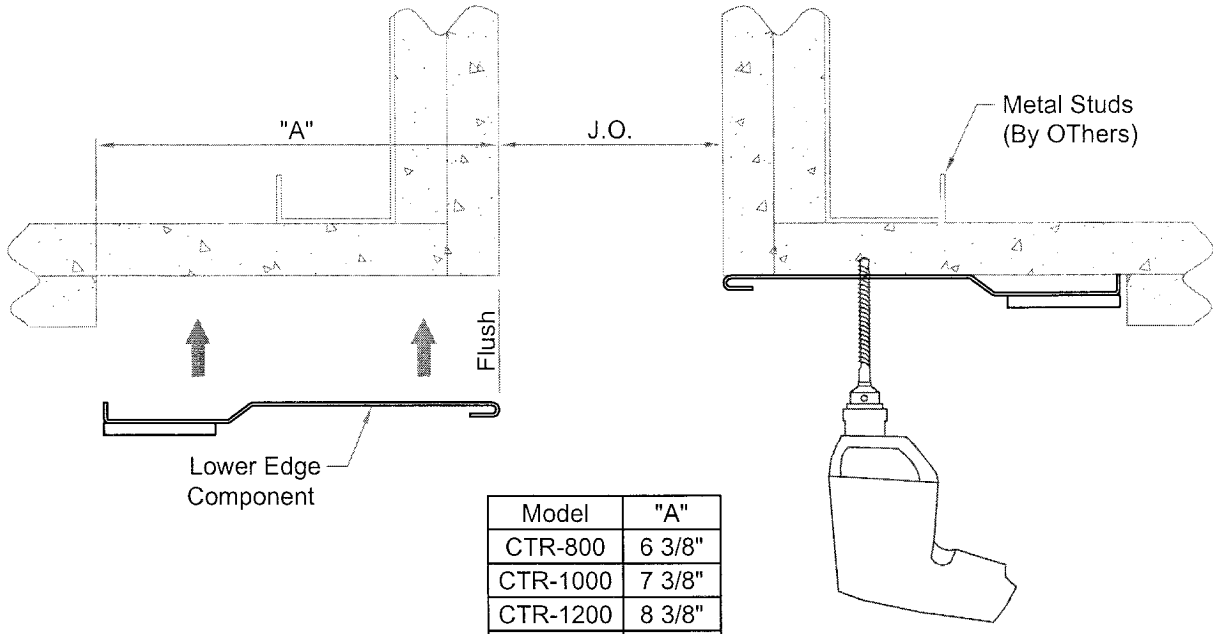

Model	"A"
CTR-800	6 3/8"
CTR-1000	7 3/8"
CTR-1200	8 3/8"
CTR-1800	11 3/8"
CTR-2400	14 3/8"

1 Position Galvanized steel lower edge component until Flush with Joint Opening. Field drill holes through the steel lower component and metal stud spaced at 18" O.C. Size drill bit according to required fastener.

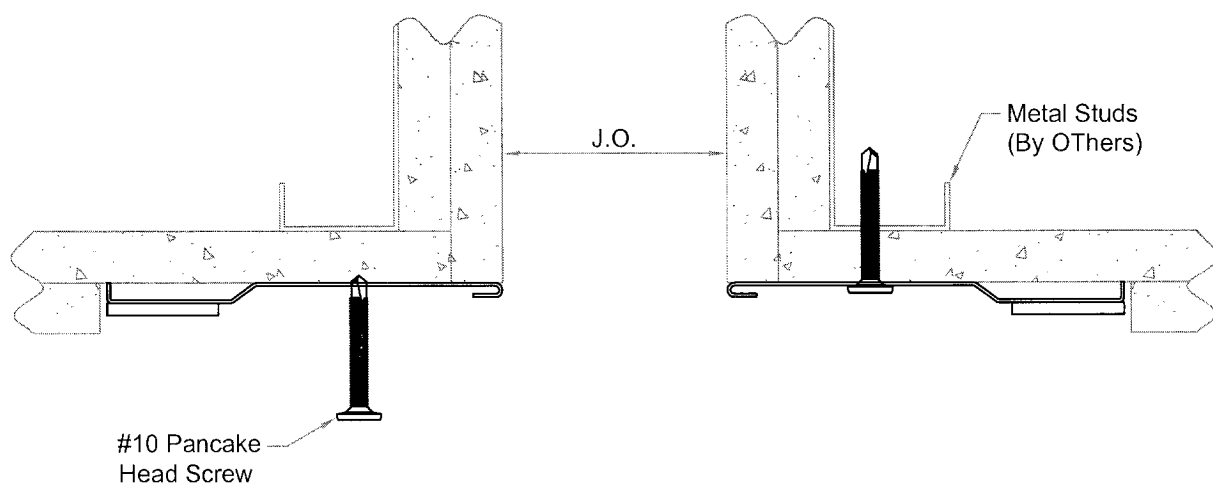

2 Install Galvanized steel lower edge component with #10 Pancake Head Screws spaced at 18" O.C.

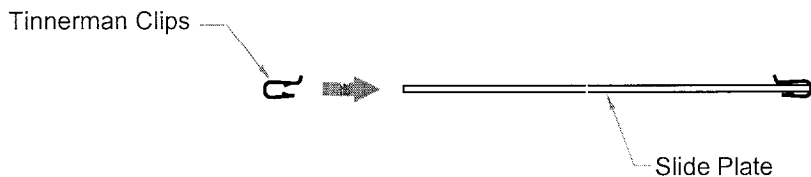

3 Position and install Tinnerman Clips spaced at 24" O.C. starting at 12" in from either end.

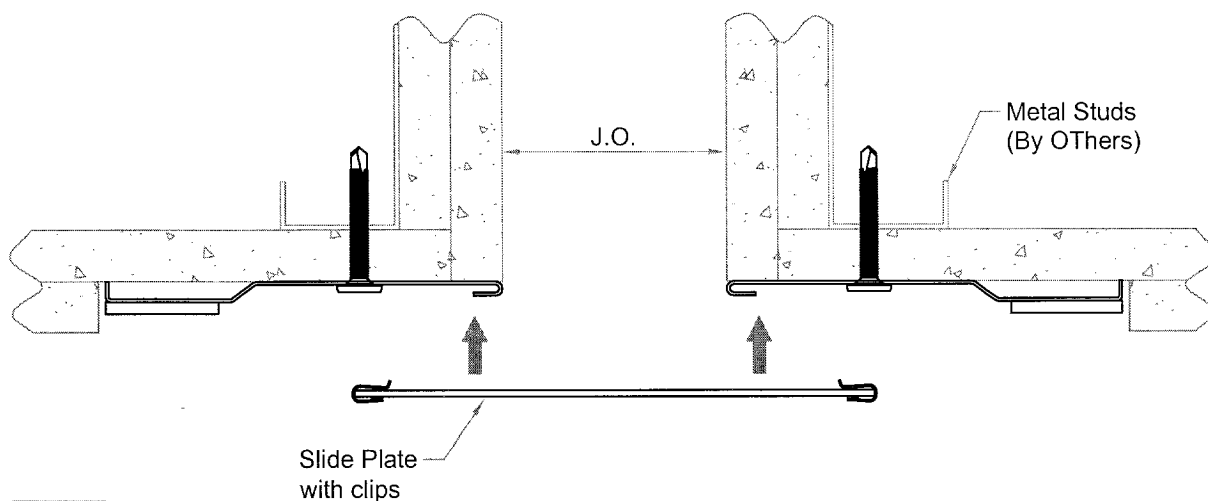

4 Position and center Slide Plate with clips against the galvanized steel lower edge component.

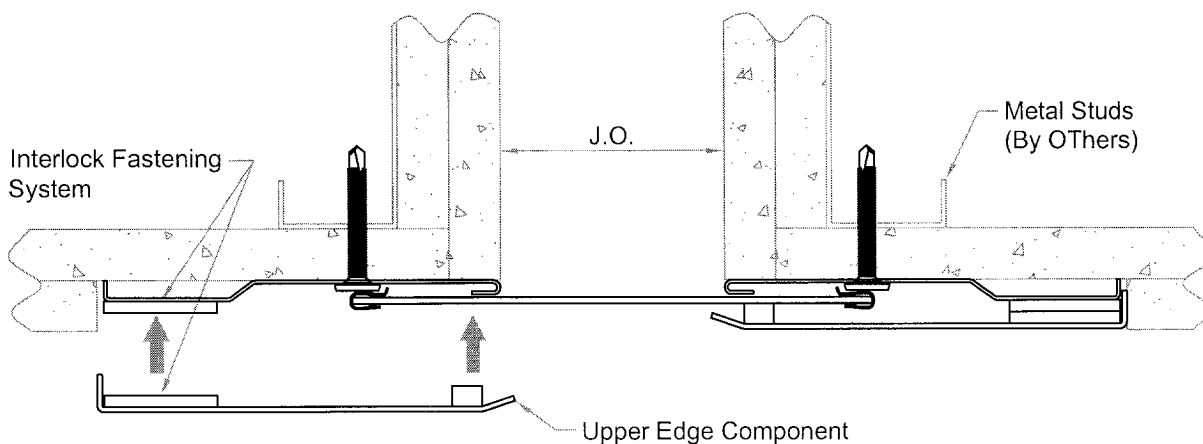

5 Align Upper Edge component and attach to lower edge profile with the structural Interlock Fastening System. Press firmly against Upper Edge Component by hand to ensure complete meshing of the fastening system.
Note: If required utilize a rubber mallet to ensure complete lock. Exercise care to avoid damage to expansion joint cover.